

Supplemental Official OCS Block Diagram

OCS Planning Area Name	North Aleutian Basin	Leasing Map/ OPD Number	NO04-06
Leasing Map / OPD Name	Ugashik	Block Number	6116
Submerged Lands Act Boundary Radius	5556.000	Datum	NAD 83/WGS 84
		Units	Meters
		Previous SOBD Signature Date	

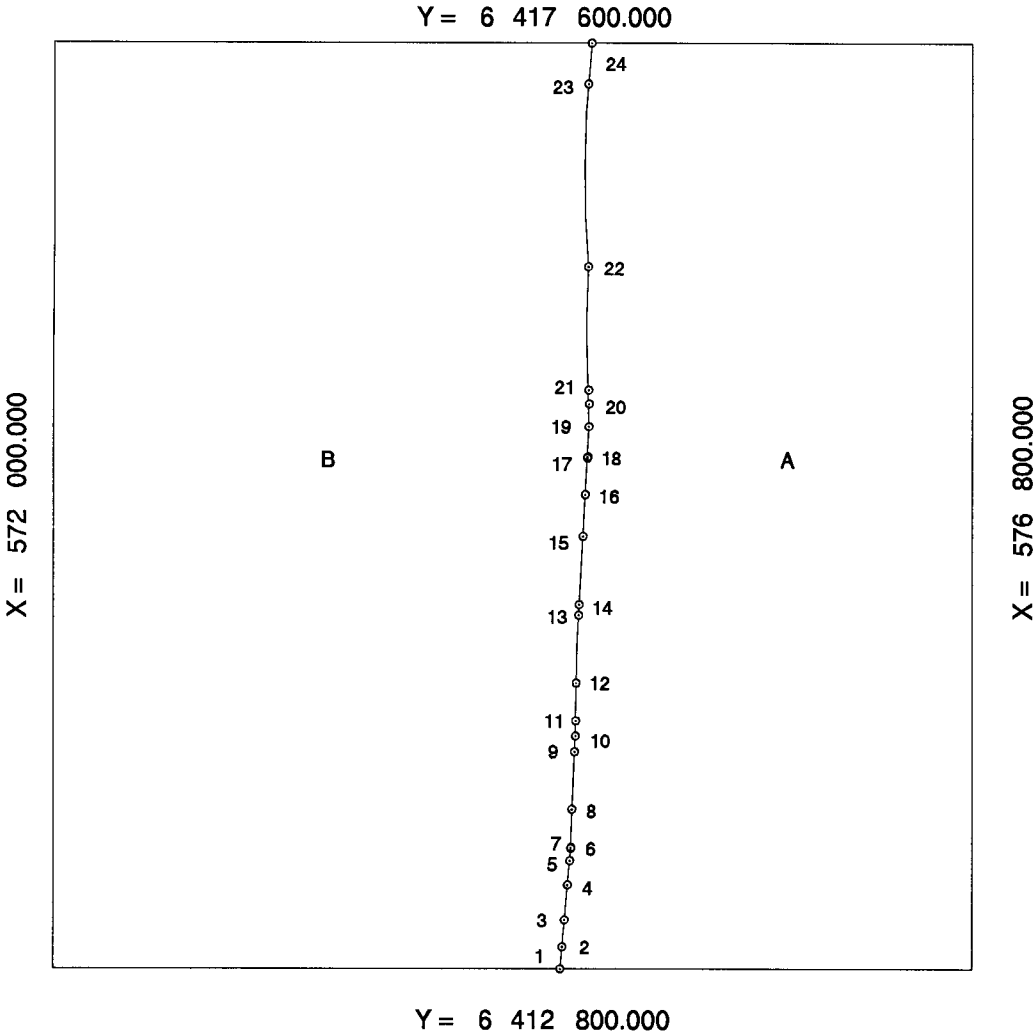

State Area	A = 981.885702 ha
Federal 8(g) Area	B = 1322.114298 ha
Total Area	2304.000000 ha

Offshore Intersections				Contributing Baseline Points				Tangent Baseline End Points	
	X	Y		X	Y			X	Y
1	574 650.621	6 412 800.000	1 - 2	580 189.303	6 412 361.660				
2	574 660.826	6 412 913.994	2 - 3	580 201.801	6 412 505.672				
3	574 672.929	6 413 054.040	3 - 4	580 214.111	6 412 648.534				
4	574 689.237	6 413 235.817	4 - 5	580 227.414	6 412 791.149				
5	574 700.737	6 413 361.216	5 - 6	580 240.398	6 412 935.433				
6	574 706.004	6 413 424.940	6 - 7	580 258.403	6 413 224.942				
7	574 706.171	6 413 429.530	7 - 8	580 261.876	6 413 372.274				
8	574 711.625	6 413 624.950	8 - 9	580 266.615	6 413 519.038				
9	574 725.295	6 413 922.652	9 - 10	580 275.280	6 413 664.199				
10	574 729.694	6 414 004.212	10 - 11	580 285.516	6 413 959.774				
11	574 730.895	6 414 083.552	11 - 12	580 286.843	6 414 107.581				
12	574 733.512	6 414 279.770	12 - 13	580 289.462	6 414 256.234				
13	574 746.107	6 414 630.869	13 - 14	580 297.522	6 414 405.198				
14	574 748.631	6 414 686.164	14 - 15	580 303.058	6 414 553.975				
15	574 768.411	6 415 040.616	15 - 16	580 321.139	6 414 849.963				
16	574 779.951	6 415 255.391	16 - 17	580 330.035	6 414 999.063				
17	574 791.936	6 415 444.710	17 - 18	580 340.157	6 415 150.796				
18	574 792.233	6 415 450.251	18 - 19	580 346.149	6 415 298.096				
19	574 798.729	6 415 606.742	19 - 20	580 354.704	6 415 590.222				
20	574 800.365	6 415 726.070	20 - 21	580 349.225	6 416 007.653				

Leasing Map/
OPD Number NO04-06
Block Number 6116

21	574	797.206	6 415	797.365	21 -22	580	342.433	6 416	143.188
22	574	794.435	6 416	441.279	22 -23	580	329.500	6 416	923.145
23	574	793.019	6 417	388.454	23 -24	580	338.605	6 417	048.439
24	574	810.050	6 417	600.000					

For the State 6/24/05 Date