

Supplemental Official OCS Block Diagram

OCS Planning Area Name Eastern Gulf Of Mexico  
Leasing Map / OPD Name Pensacola

☒ State Seaward Boundary Radius 54 684.930  
☐ Limit of '8(g) Zone' Radius

☒ Feet  
☐ Meters

Leasing Map/  
OPD Number NH16-05  
Block Number 842  
Datum NAD 27  
☒ Previous SOBD  
Signature Date 01-APR-92

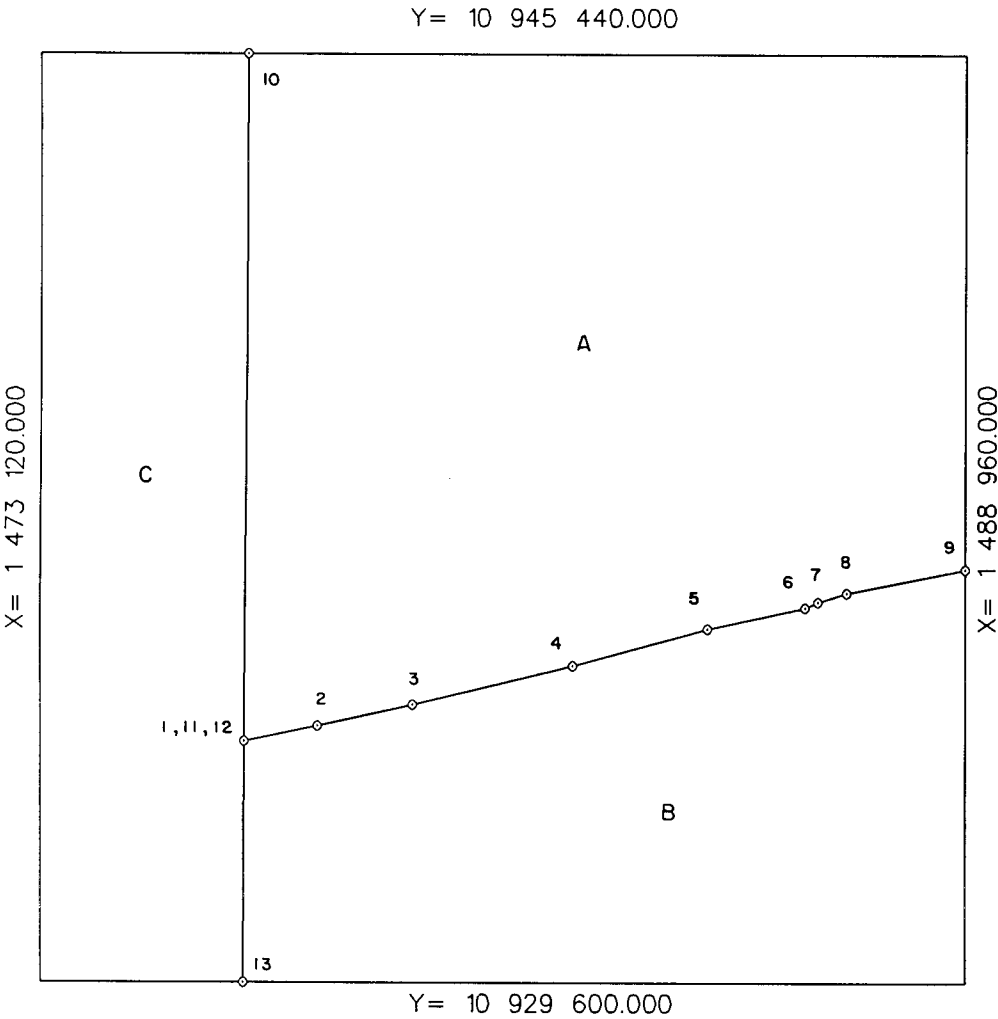

State  
Area A = 2905.310509A  
  
Federal  
8(g) Area B = 1587.327527A  
  
Boundary  
Disputed  
  
Federal  
Non-8(g)  
Area C = 1267.361964A  
  
8(g)  
Disputed  
  
Federal  
Withdrawn  
Area  
  
Federal  
Deferred  
Area  
  
Total Area 5760.000000A

Offshore Intersections			
	X	Y	
1	1 476 586.881	10 933 724.236	
2	1 477 848.232	10 933 986.250	
3	1 479 473.322	10 934 343.840	
4	1 482 215.125	10 935 021.837	
5	1 484 529.407	10 935 657.964	
6	1 486 210.181	10 936 017.210	
7	1 486 438.429	10 936 115.329	
8	1 486 924.742	10 936 265.214	
9	1 488 960.000	10 936 676.105	
10	1 476 643.531	10 945 440.000	
11	1 476 586.881	10 933 724.236	
12	1 476 586.881	10 933 724.236	
13	1 476 566.976	10 929 600.000	

Contributing Baseline Points			
	X	Y	
1-2	1 466 096.330	10 987 393.500	
* 2-3	1 466 096.330	10 987 393.500	
3-4	1 467 721.420	10 987 751.090	
* 4-5	1 467 721.420	10 987 751.090	
* 5-6	1 471 556.720	10 988 805.300	
6-7	1 464 727.273	10 986 305.640	
* 7-8	1 469 443.384	10 988 100.657	
8-9	1 477 122.507	10 990 064.450	

\*Tangent Segment

*Talman F. Hummel* 03/01/99  
For the Director, MMS Date

For the State  
ALABAMA Date