

Supplemental Official OCS Block Diagram

OCS Planning Area Name	Central Gulf of Mexico / LND	Leasing Map/OPD Number	NH16-05
Leasing Map / OPD Name	Pensacola	Block Number	842
Submerged Lands Act Boundary Radius	54 684.930	Datum	NAD 27
		Units	Feet
		Previous SOBD Signature Date	01-APR-1992

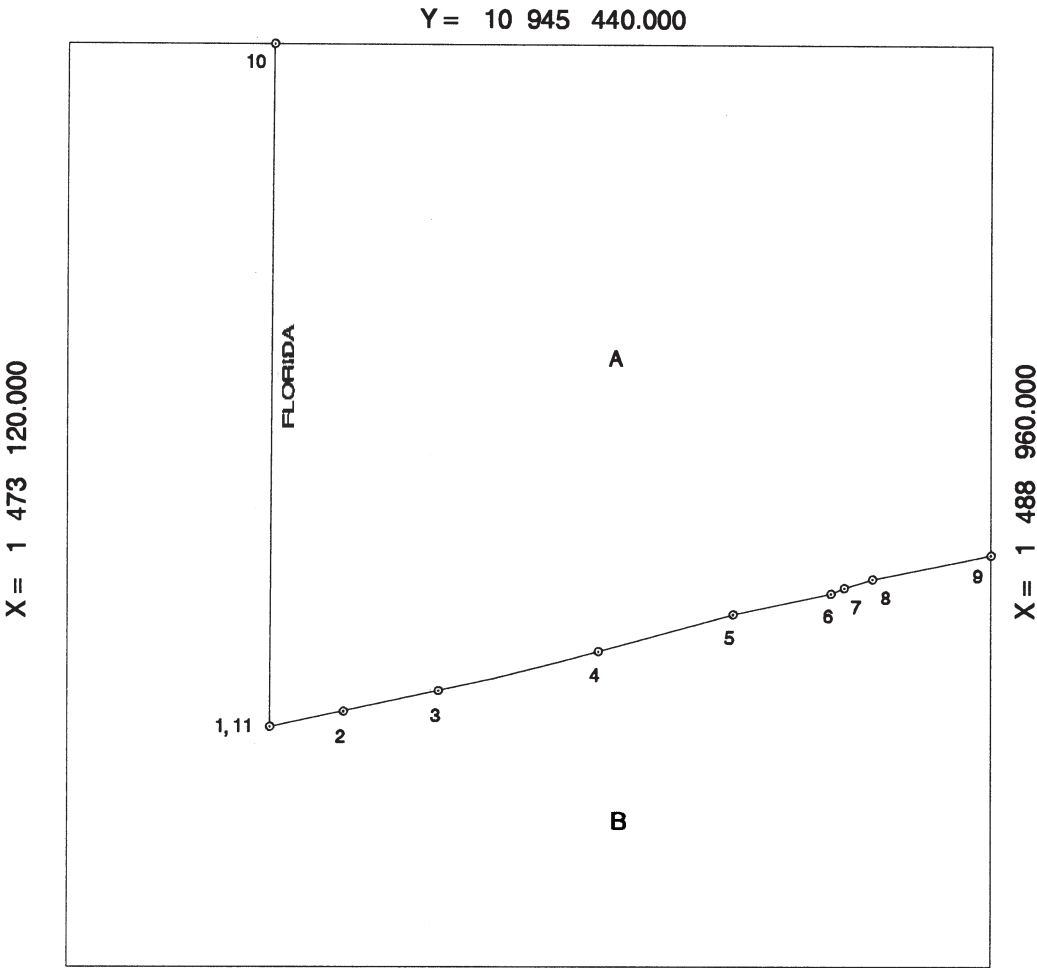

State Area	A = 2905.310000 ac
Federal 8(g) Area	B = 2854.690000 ac
Total Area	5760.000000 ac

Offshore Intersections				Contributing Baseline Points				Tangent Baseline End Points	
X		Y		X		Y		X	Y
1	1 476 586.881	10 933	724.236	1 - 2	1 466 096.330	10 987	393.500		
2	1 477 848.232	10 933	986.250	* 2 - 3	1 466 096.330	10 987	393.500		
3	1 479 473.322	10 934	343.840	3 - 4	1 467 721.420	10 987	751.090		
4	1 482 215.125	10 935	021.837	* 4 - 5	1 467 721.420	10 987	751.090		
5	1 484 529.407	10 935	657.964	* 5 - 6	1 471 556.720	10 988	805.300		
6	1 486 210.181	10 936	017.210	6 - 7	1 464 727.273	10 986	305.640		
7	1 486 438.429	10 936	115.329	* 7 - 8	1 469 443.384	10 988	100.657		
8	1 486 924.742	10 936	265.214	8 - 9	1 477 122.507	10 990	064.450		
9	1 488 960.000	10 936	676.105						
10	1 476 643.614	10 945	440.000						
11	1 476 586.881	10 933	724.236						

A = Florida State Area (B)
B =ward of the SLA (A)
Alabama-Florida Lateral Boundary
Submerged Lands Act Boundary

Daryl S. Vardag 01-OCT-2014
For the Director, BOEM Date

For the State Date