

UNITED STATES DEPARTMENT OF INTERIOR  
MINERALS MANAGEMENT SERVICE

SUPPLEMENTAL OFFICIAL  
OCS 8-G BLOCK DIAGRAM

SALE NO. \_\_\_\_\_  
☐ FED.-STATE SEAWARD BDY.  
RADIUS \_\_\_\_\_  
☒ B-G BOUNDARY  
RADIUS 36 468.91'

West  
OPD NAME Cameron Area  
OPD NO. LA Map 1  
BLOCK NO. 66  
OCS LEASE NO. \_\_\_\_\_  
STATE LEASE NO. \_\_\_\_\_

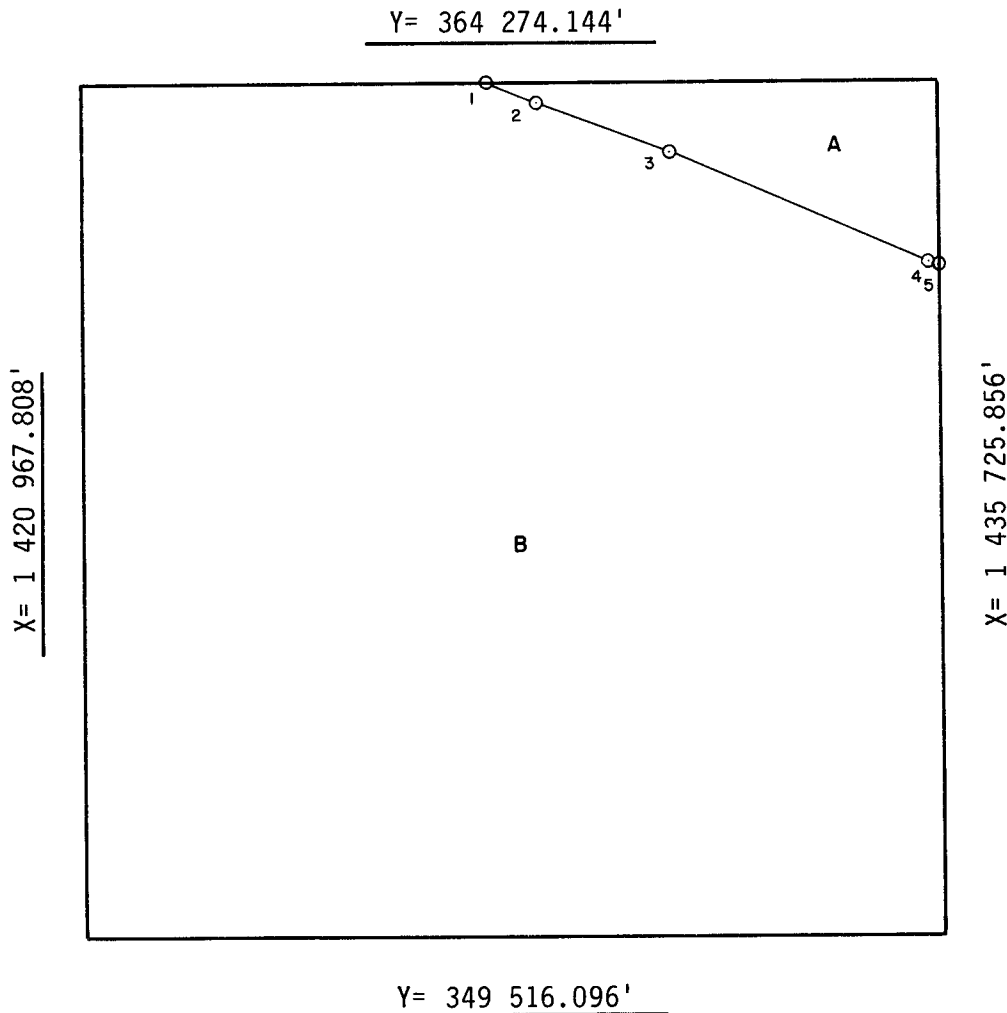

INTERSECTIONS

	X	Y
1	1 427 930.727'	364 274.144'
2	1 428 802.21'	363 956.79'
3	1 431 102.27'	363 088.04'
4	1 435 607.97'	361 163.19'
5	1 435 725.856'	361 113.074'

ARC CENTERS

	X	Y
*1-2	1 436 899'	399 820'
*2-3	1 441 485'	398 150'
*3-4	1 444 715'	396 930'
4-5	1 449 935'	394 700'

\*TANGENT SEGMENT

FEDERAL AREA B= 4726.41A STATE AREA \_\_\_\_\_ 8G AREA A= 273.59A DISPUTED AREA \_\_\_\_\_  
% \_\_\_\_\_ % \_\_\_\_\_ % \_\_\_\_\_ % \_\_\_\_\_

COMPUTATIONS BY JE/DC DATE 8-8-85

DRAFTED BY QV DATE 9-30-85

CHECKED BY AJD DATE 12/22/86

FOR THE DIRECTOR

Toland H. Henshler

DATE 1-16-87

FOR THE STATE

DATE \_\_\_\_\_