

UNITED STATES DEPARTMENT OF INTERIOR  
MINERALS MANAGEMENT SERVICE

SUPPLEMENTAL OFFICIAL  
OCS 8-G BLOCK DIAGRAM

SALE NO. \_\_\_\_\_  
☐ FED.-STATE SEAWARD BDY.  
RADIUS \_\_\_\_\_  
☒ B-G BOUNDARY  
RADIUS 36 468.91'

West  
OPD NAME Cameron Area  
OPD NO. LA Map 1  
BLOCK NO. 41  
OCS LEASE NO. \_\_\_\_\_  
STATE LEASE NO. \_\_\_\_\_

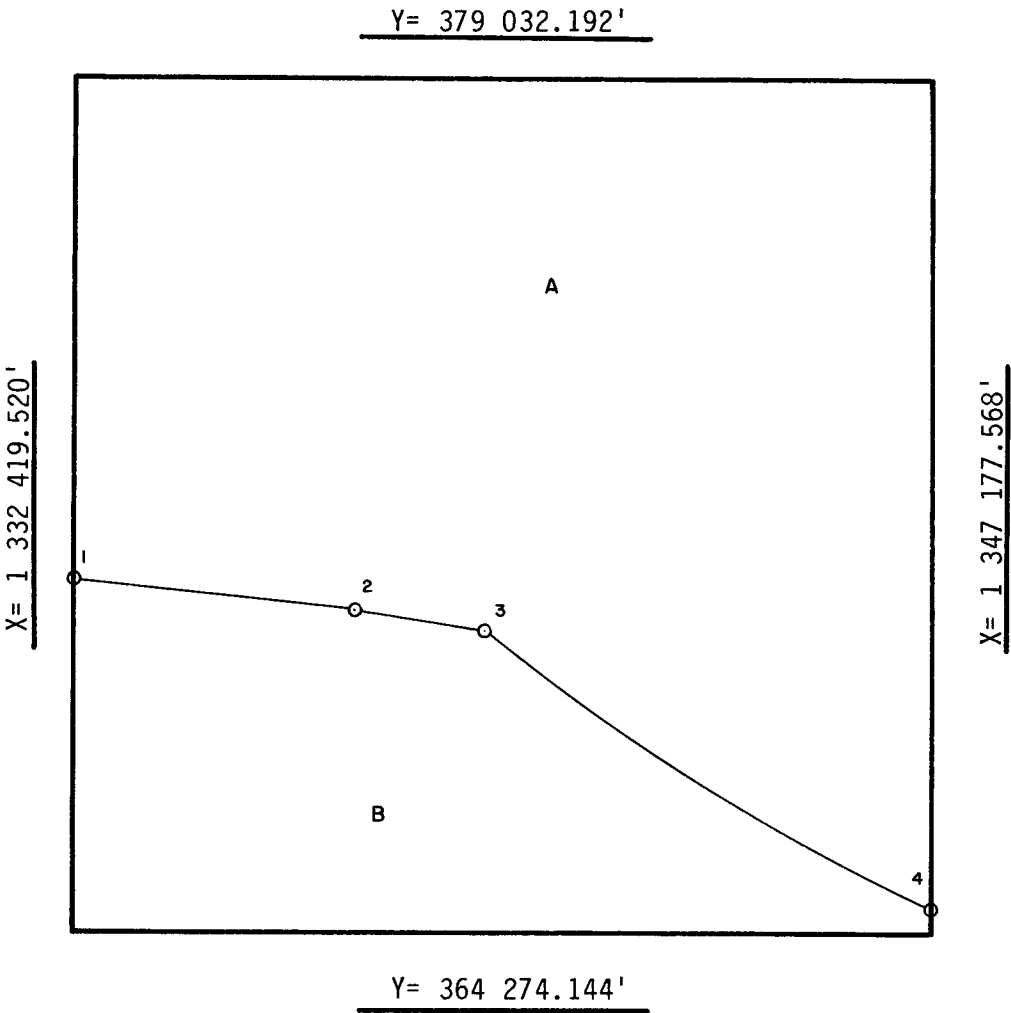

INTERSECTIONS

	X	Y
1	<u>1 332 419.520'</u>	<u>370 337.596'</u>
2	<u>1 337 244.63'</u>	<u>369 793.80'</u>
3	<u>1 339 480.59'</u>	<u>369 468.02'</u>
4	<u>1 347 177.568'</u>	<u>364 689.364'</u>
	_____	_____
	_____	_____
	_____	_____
	_____	_____
	_____	_____
	_____	_____

ARC CENTERS

	X	Y
*1-2	<u>1 333 745'</u>	<u>406 888'</u>
*2-3	<u>1 341 917'</u>	<u>405 967'</u>
3-4	<u>1 362 416'</u>	<u>397 822'</u>
	_____	_____
	_____	_____
	_____	_____
	_____	_____
	_____	_____
	_____	_____

\*TANGENT SEGMENT

FEDERAL AREA B=1372.86A STATE AREA \_\_\_\_\_ 8G AREA A=3627.14A DISPUTED AREA \_\_\_\_\_  
% \_\_\_\_\_ % \_\_\_\_\_ % \_\_\_\_\_ % \_\_\_\_\_

COMPUTATIONS BY JF/DC DATE 8-8-86  
DRAFTED BY JK DATE 11-24-86  
CHECKED BY AJD DATE 12/22/86

FOR THE DIRECTOR  
Island of Hawaii  
DATE 1-16-87

FOR THE STATE  
\_\_\_\_\_  
DATE \_\_\_\_\_