

UNITED STATES DEPARTMENT OF INTERIOR  
MINERALS MANAGEMENT SERVICE

SUPPLEMENTAL OFFICIAL  
OCS 8-G BLOCK DIAGRAM

East

OPD NAME Cameron Area

OPD NO. LA Map 2

BLOCK NO. 35

OCS LEASE NO. \_\_\_\_\_

STATE LEASE NO. \_\_\_\_\_

SALE NO. \_\_\_\_\_

☐ FED.-STATE SEAWARD BDY.

RADIUS \_\_\_\_\_

☒ 8-G BOUNDARY

RADIUS 36 468.91'

Y= 315 725.856'

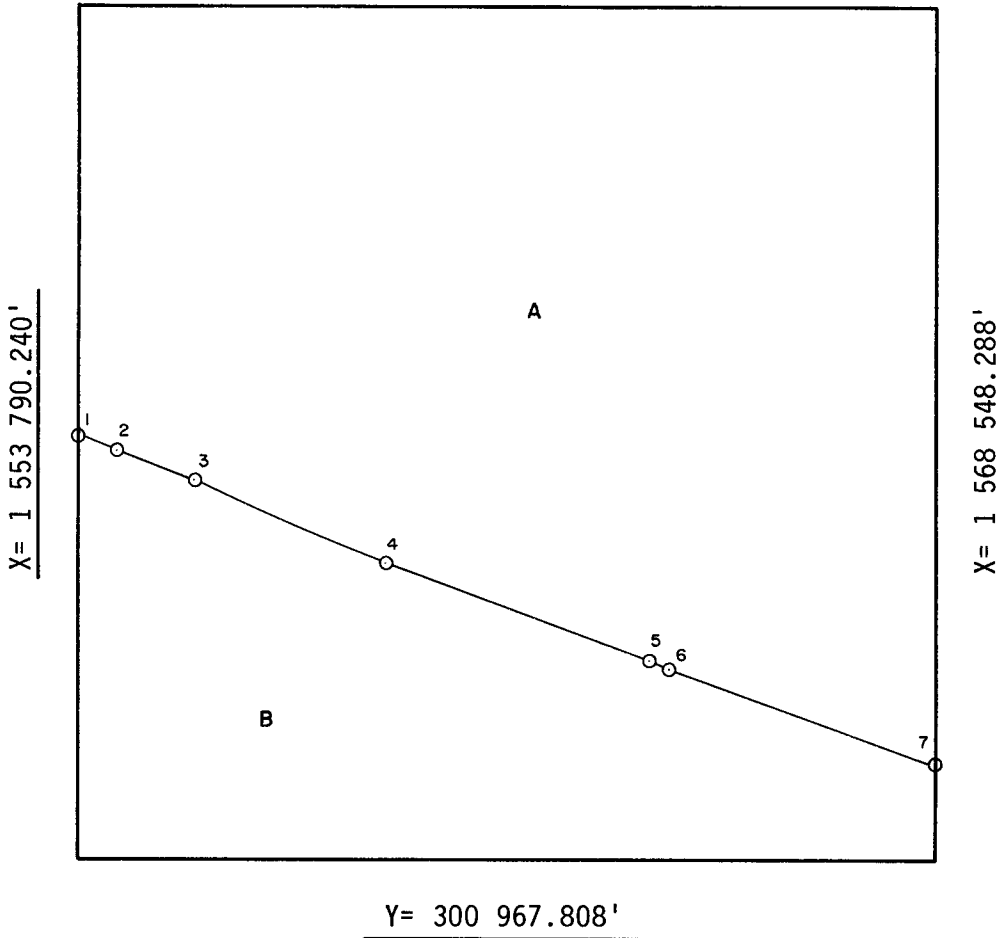

INTERSECTIONS

	X	Y
1	1 553 790.240'	308 275.922'
2	1 554 456.37'	308 008.83'
3	1 555 751.94'	307 504.09'
4	1 559 073.19'	306 096.02'
5	1 563 613.19'	304 431.02'
6	1 563 994.96'	304 293.41'
7	1 568 548.288'	302 680.776'

ARC CENTERS

	X	Y
1-2	1 567 695'	341 990'
*2-3	1 567 695'	341 990'
3-4	1 571 630'	340 335'
*4-5	1 571 630'	340 335'
5-6	1 576 170'	338 670'
*6-7	1 576 170'	338 670'

\*TANGENT SEGMENT

FEDERAL AREA B= 1494.63A STATE AREA \_\_\_\_\_ 8G AREA A= 3505.37A DISPUTED AREA \_\_\_\_\_  
% \_\_\_\_\_ % \_\_\_\_\_ % \_\_\_\_\_ % \_\_\_\_\_

COMPUTATIONS BY JE/DC DATE 10-2-85

DRAFTED BY QV. DATE 10-3-85

CHECKED BY A/C DATE 12/22/86

FOR THE DIRECTOR

Telma St. John Mahlen

DATE 1-16-87

FOR THE STATE

DATE \_\_\_\_\_