

UNITED STATES DEPARTMENT OF INTERIOR  
MINERALS MANAGEMENT SERVICE

SUPPLEMENTAL OFFICIAL  
OCS 8-G BLOCK DIAGRAM

SALE NO. \_\_\_\_\_  
☒ FED.-STATE SEAWARD BDY.  
RADIUS 18 240.6'  
☐ 8-G BOUNDARY  
RADIUS \_\_\_\_\_

OPD NAME Vermilion Area  
OPD NO. LA Map 3  
BLOCK NO. 27  
OCS LEASE NO. \_\_\_\_\_  
STATE LEASE NO. \_\_\_\_\_

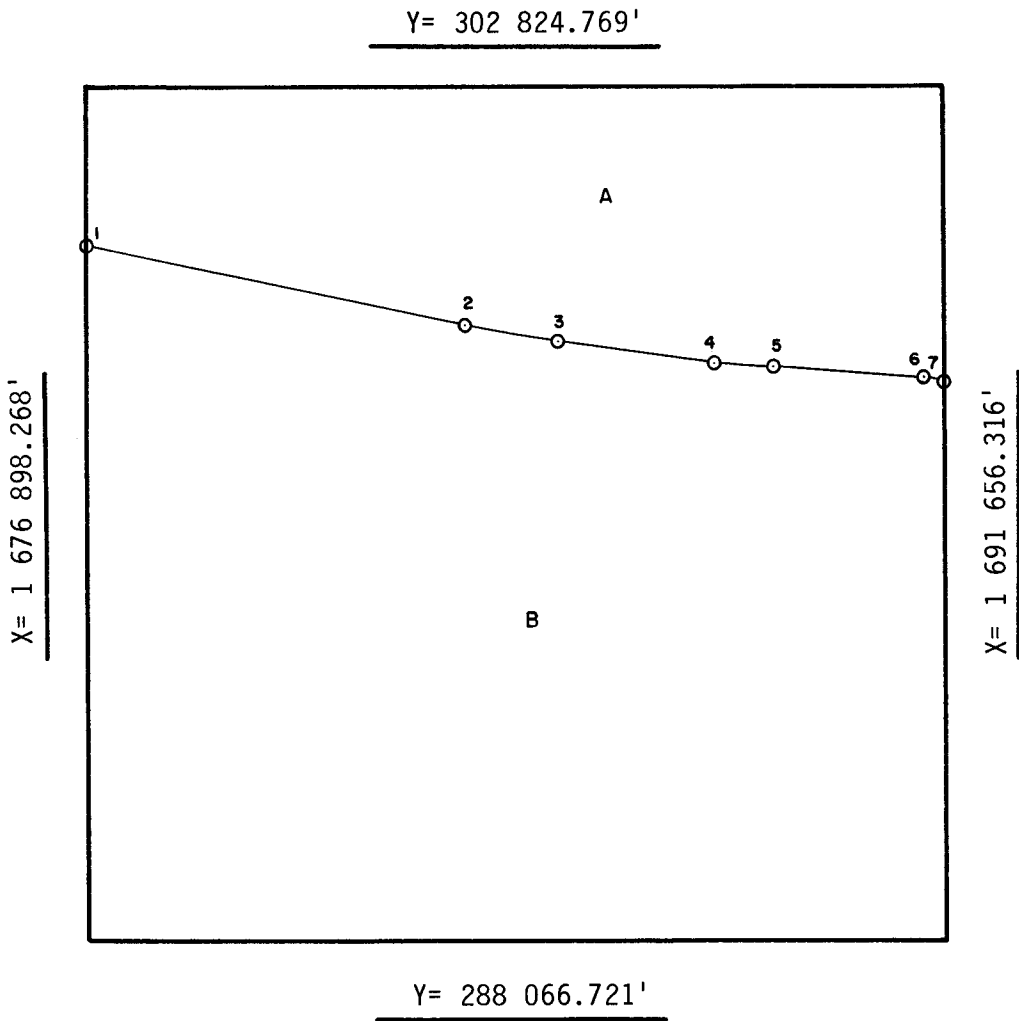

INTERSECTIONS

	X	Y
1	1 676 898.268'	300 099.023'
2	1 683 393'	298 686'
3	1 684 999'	298 411'
4	1 687 709'	298 071'
5	1 688 714'	297 973'
6	1 691 302'	297 793'
7	1 691 656.316'	297 772.198'

ARC CENTERS

X	Y

FEDERAL AREA \_\_\_\_\_ STATE AREA A=1400.56A 8G AREA B=3599.44A DISPUTED AREA \_\_\_\_\_  
% \_\_\_\_\_ % \_\_\_\_\_ % \_\_\_\_\_ % \_\_\_\_\_

COMPUTATIONS BY JF/DC DATE 10-8-85  
DRAFTED BY QV DATE 11-21-86  
CHECKED BY A/CO DATE 12/18/86

FOR THE DIRECTOR  
Island of Guam  
DATE 1-16-87

FOR THE STATE  
\_\_\_\_\_  
DATE \_\_\_\_\_