

UNITED STATES DEPARTMENT OF INTERIOR
MINERALS MANAGEMENT SERVICE

SUPPLEMENTAL OFFICIAL
OCS 8-G BLOCK DIAGRAM

SALE NO. _____
☐ FED.-STATE SEAWARD BDY.
RADIUS _____
☒ 8-G BOUNDARY
RADIUS 36 468.91'

OPD NAME Vermilion Area
OPD NO. LA Map 3
BLOCK NO. 33
OCS LEASE NO. _____
STATE LEASE NO. _____

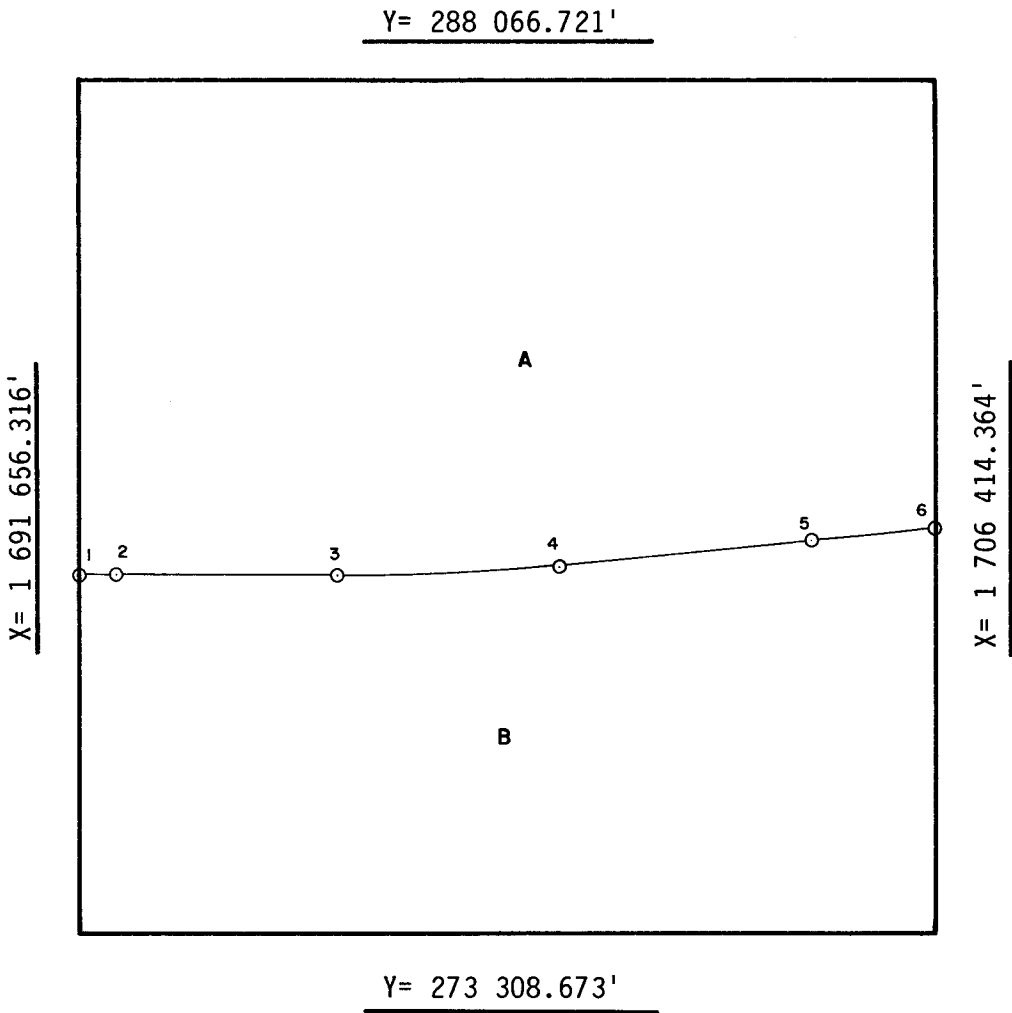

INTERSECTIONS

	X	Y
1	1 691 656.316'	279 532.487'
2	1 692 327.51'	279 521.88'
3	1 696 118.51'	279 496.88'
4	1 699 928.74'	279 671.22'
5	1 704 249.74'	280 096.22'
6	1 706 414.364'	280 374.747'

ARC CENTERS

	X	Y
1-2	1 692 568'	315 990'
*2-3	1 692 568'	315 990'
3-4	1 696 359'	315 965'
*4-5	1 696 359'	315 965'
5-6	1 700 680'	316 390'

*TANGENT SEGMENT

FEDERAL AREA B= 2177.34A STATE AREA _____ 8G AREA A= 2822.66A DISPUTED AREA _____
% _____ % _____ % _____ % _____

COMPUTATIONS BY LF/DC DATE 10-8-85

DRAFTED BY QV DATE 10-9-85

CHECKED BY AJO DATE 10/8/86

FOR THE DIRECTOR

Telma J. Hymahlen

DATE 5-16-87

FOR THE STATE

DATE _____