

UNITED STATES DEPARTMENT OF INTERIOR  
MINERALS MANAGEMENT SERVICE

SUPPLEMENTAL OFFICIAL  
OCS 8-G BLOCK DIAGRAM

SALE NO. \_\_\_\_\_  
☐ FED.-STATE SEAWARD BDY.  
RADIUS \_\_\_\_\_  
☒ 8-G BOUNDARY  
RADIUS 36 468.91'

South  
OPD NAME Timbalier Area  
OPD NO. LA Map 6  
BLOCK NO. 36  
OCS LEASE NO. \_\_\_\_\_  
STATE LEASE NO. \_\_\_\_\_

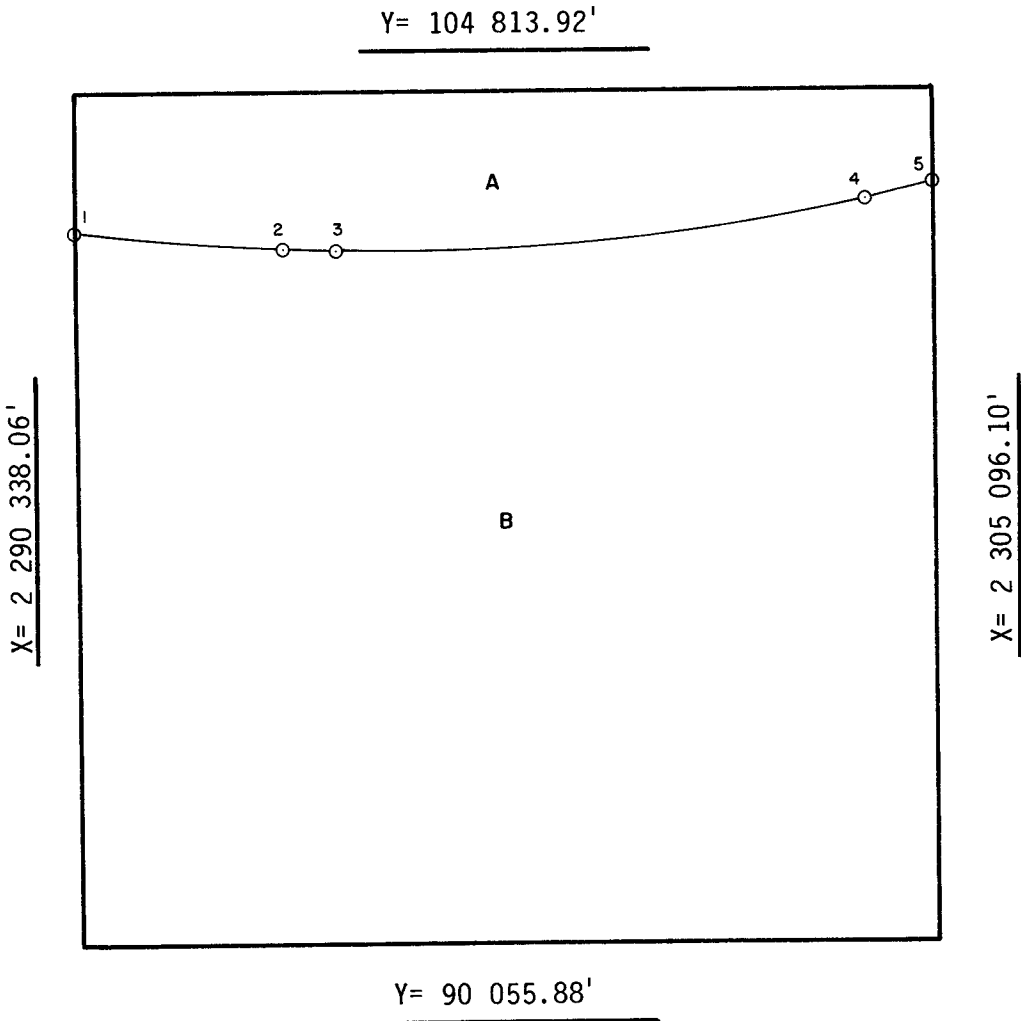

INTERSECTIONS

	X	Y
1	<u>2 290 338.06'</u>	<u>102 399.15'</u>
2	<u>2 293 884.40'</u>	<u>102 102.85'</u>
3	<u>2 294 781.40'</u>	<u>102 071.85'</u>
4	<u>2 303 940.14'</u>	<u>102 915.84'</u>
5	<u>2 305 096.10'</u>	<u>103 172.31'</u>
	_____	_____
	_____	_____
	_____	_____
	_____	_____
	_____	_____

ARC CENTERS

	X	Y
1-2	<u>2 295 144'</u>	<u>138 550'</u>
*2-3	<u>2 295 144'</u>	<u>138 550'</u>
3-4	<u>2 296 041'</u>	<u>138 519'</u>
*4-5	<u>2 296 041'</u>	<u>138 519'</u>
	_____	_____
	_____	_____
	_____	_____
	_____	_____
	_____	_____

\*TANGENT SEGMENT

FEDERAL AREA B= 4157.04A STATE AREA \_\_\_\_\_ 8G AREA A= 842.96A DISPUTED AREA \_\_\_\_\_  
% \_\_\_\_\_ % \_\_\_\_\_ % \_\_\_\_\_ % \_\_\_\_\_

COMPUTATIONS BY ADC DATE 11-4-85  
DRAFTED BY QV DATE 5-29-86  
CHECKED BY MEY DATE 1-18-87

FOR THE DIRECTOR  
Island of Guam  
DATE 5-16-87

FOR THE STATE  
\_\_\_\_\_  
DATE \_\_\_\_\_