

UNITED STATES DEPARTMENT OF INTERIOR
MINERALS MANAGEMENT SERVICE

SUPPLEMENTAL OFFICIAL
OCS 8-G BLOCK DIAGRAM

SALE NO. _____
☐ FED.-STATE SEAWARD BDY.
RADIUS _____
☒ 8-G BOUNDARY
RADIUS 36 468.91'

Grand
Isle Area
OPD NAME _____
OPD NO. LA Map 7
BLOCK NO. 23
OCS LEASE NO. _____
STATE LEASE NO. _____

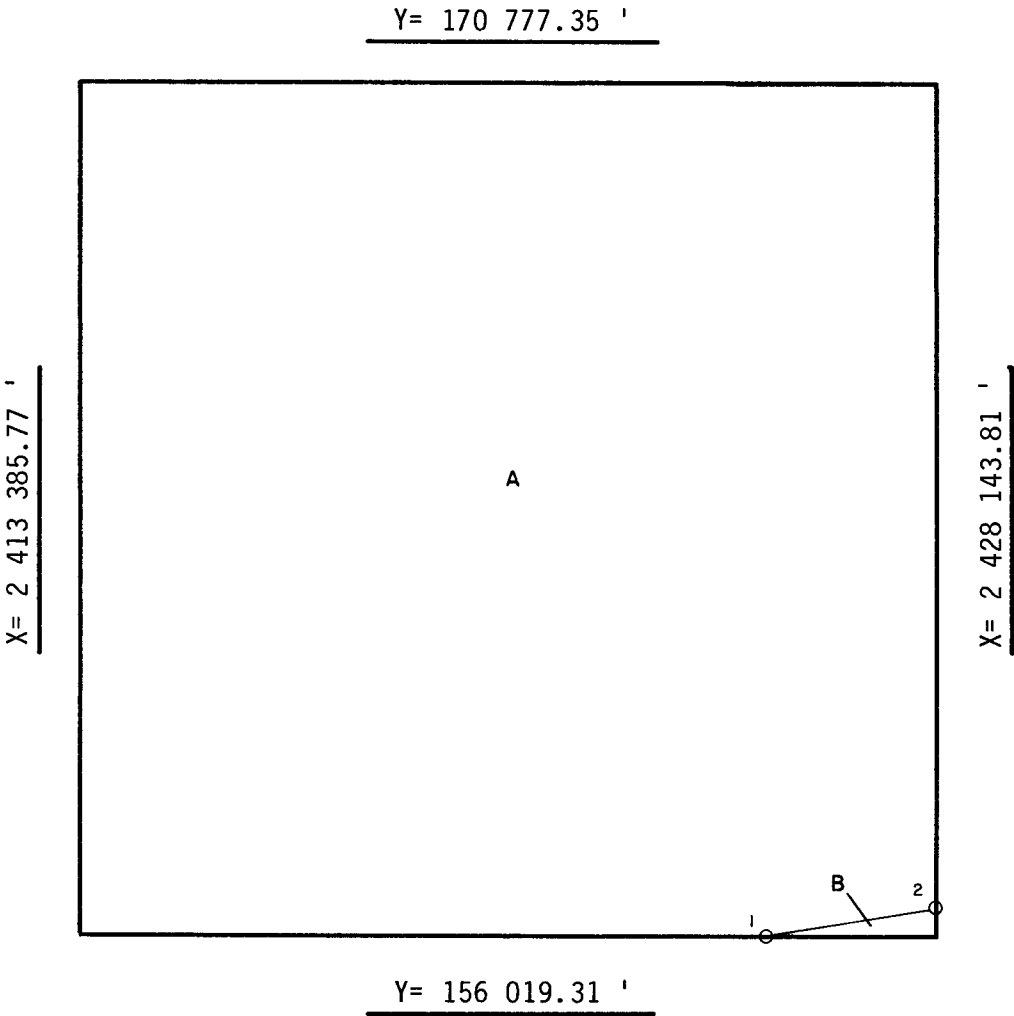

INTERSECTIONS

ARC CENTERS

	X	Y		X	Y
1	<u>2 425 182.92'</u>	<u>156 019.31'</u>	*1-2	<u>2 406 890'</u>	<u>189 733'</u>
2	<u>2 428 143.81'</u>	<u>156 564.50'</u>			

*TANGENT SEGMENT

FEDERAL AREA B= 18.53A STATE AREA _____ 8G AREA A= 4981.47A DISPUTED AREA _____
% _____ % _____ % _____ % _____

COMPUTATIONS BY WDC DATE 11-6-85 FOR THE DIRECTOR Toland/Hammah FOR THE STATE _____
DRAFTED BY QV DATE 5-30-86 DATE 5-16-87 _____
CHECKED BY WDC DATE 1-12-87 DATE _____