

UNITED STATES DEPARTMENT OF INTERIOR  
MINERALS MANAGEMENT SERVICE

SUPPLEMENTAL OFFICIAL  
OCS 8-G BLOCK DIAGRAM

SALE NO. \_\_\_\_\_  
☒ FED.-STATE SEAWARD BDY.  
RADIUS 18 240.6'  
☐ B-G BOUNDARY  
RADIUS \_\_\_\_\_

Grand  
OPD NAME Isle Area  
OPD NO. LA Map 7  
BLOCK NO. 18  
OCS LEASE NO. \_\_\_\_\_  
STATE LEASE NO. \_\_\_\_\_

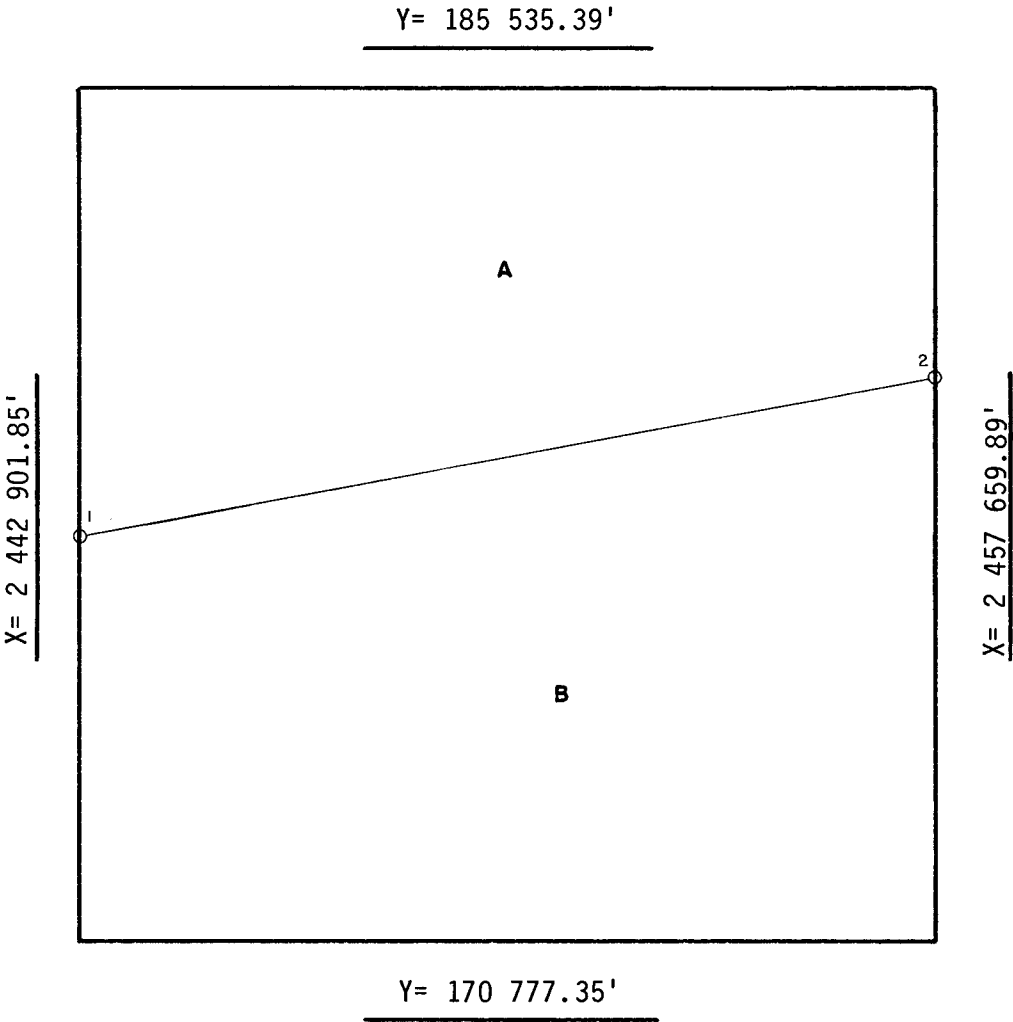

INTERSECTIONS

	X	Y
1	<u>2 442 901.85'</u>	<u>177 816.66'</u>
2	<u>2 457 659.89'</u>	<u>180 534.07'</u>
	_____	_____
	_____	_____
	_____	_____
	_____	_____
	_____	_____
	_____	_____
	_____	_____
	_____	_____

ARC CENTERS

X	Y
_____	_____
_____	_____
_____	_____
_____	_____
_____	_____
_____	_____
_____	_____
_____	_____
_____	_____

FEDERAL AREA \_\_\_\_\_ STATE AREA A=2154.77A BG AREA B=2845.23A DISPUTED AREA \_\_\_\_\_  
% \_\_\_\_\_ % \_\_\_\_\_ % \_\_\_\_\_ % \_\_\_\_\_

COMPUTATIONS BY JE/DC DATE 11-6-85  
DRAFTED BY QV DATE 11-12-86  
CHECKED BY HEU DATE 1-12-87

FOR THE DIRECTOR  
Telundt Hermaklen  
DATE 1-16-87

FOR THE STATE  
\_\_\_\_\_  
DATE \_\_\_\_\_