

UNITED STATES DEPARTMENT OF INTERIOR  
MINERALS MANAGEMENT SERVICE

SUPPLEMENTAL OFFICIAL  
OCS 8-G BLOCK DIAGRAM

Y= 186 360.50 '

West

OPD NAME Delta Area  
OPD NO. LA Map 8  
BLOCK NO. 34  
OCS LEASE NO. \_\_\_\_\_  
STATE LEASE NO. \_\_\_\_\_

SALE NO. \_\_\_\_\_  
☐ FED.-STATE SEAWARD BDY.  
RADIUS \_\_\_\_\_  
☒ 8-G BOUNDARY  
RADIUS 36 468.91'

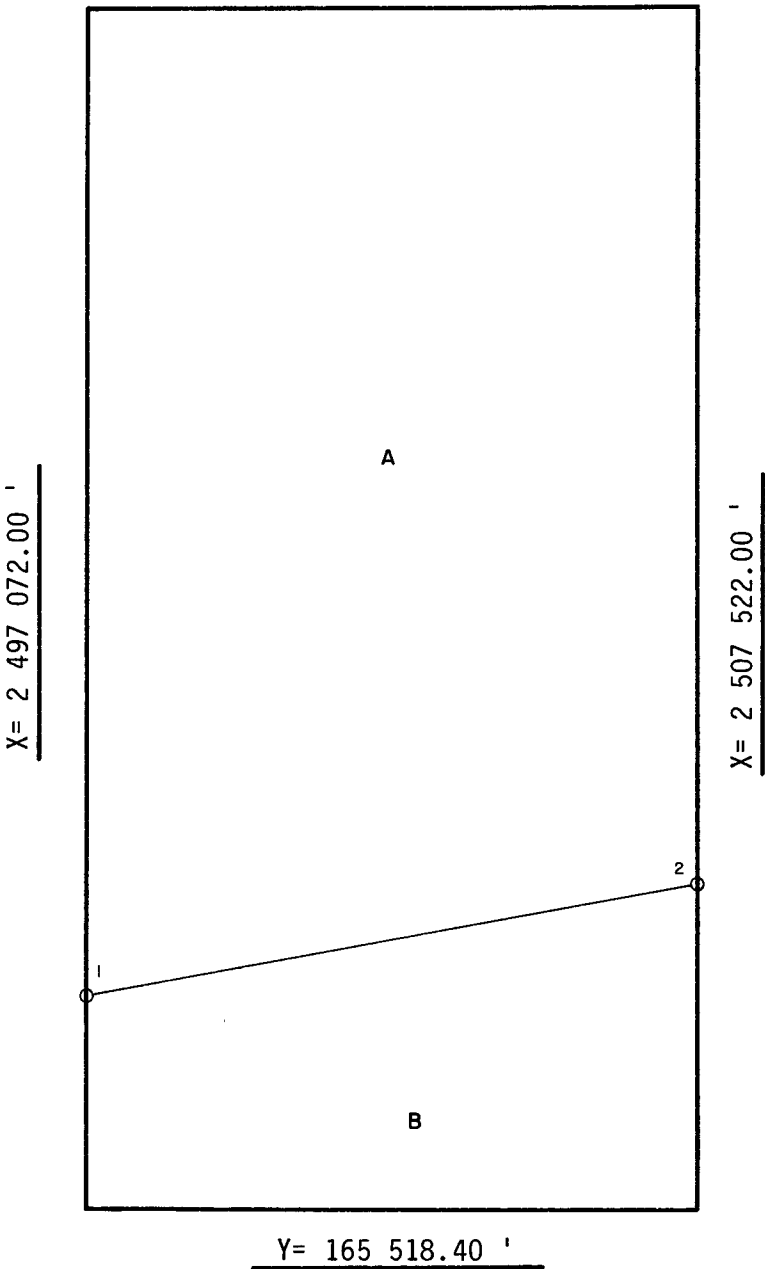

INTERSECTIONS

ARC CENTERS

1	<u>2 497 072.00'</u>	<u>169 256.32'</u>	*1-2	<u>2 406 890'</u>	<u>189 733'</u>
2	<u>2 507 522.00'</u>	<u>171 180.48'</u>		_____	_____
	_____	_____		_____	_____
	_____	_____		_____	_____
	_____	_____		_____	_____
	_____	_____		_____	_____
	_____	_____		_____	_____
	_____	_____		_____	_____
	_____	_____		_____	_____
	_____	_____		_____	_____

\*TANGENT SEGMENT

FEDERAL AREA B= 1127.53A STATE AREA \_\_\_\_\_ 8G AREA A= 3872.47A DISPUTED AREA \_\_\_\_\_  
% \_\_\_\_\_ % \_\_\_\_\_ % \_\_\_\_\_ % \_\_\_\_\_

COMPUTATIONS BY JF/DC DATE 11-14-85

FOR THE DIRECTOR

FOR THE STATE

DRAFTED BY JK DATE 5-30-86

DATE 5-16-87

DATE \_\_\_\_\_

CHECKED BY MEV DATE 1-12-87