

UNITED STATES DEPARTMENT OF INTERIOR  
MINERALS MANAGEMENT SERVICE

SUPPLEMENTAL OFFICIAL  
OCS 8-G BLOCK DIAGRAM

SALE NO. \_\_\_\_\_  
☐ FED.-STATE SEAWARD BDY.  
RADIUS \_\_\_\_\_  
☒ 8-G BOUNDARY  
RADIUS 36 468.91'

South  
Pass Area  
OPD NAME \_\_\_\_\_  
OPD NO. LA Map 9  
BLOCK NO. 44  
OCS LEASE NO. \_\_\_\_\_  
STATE LEASE NO. \_\_\_\_\_

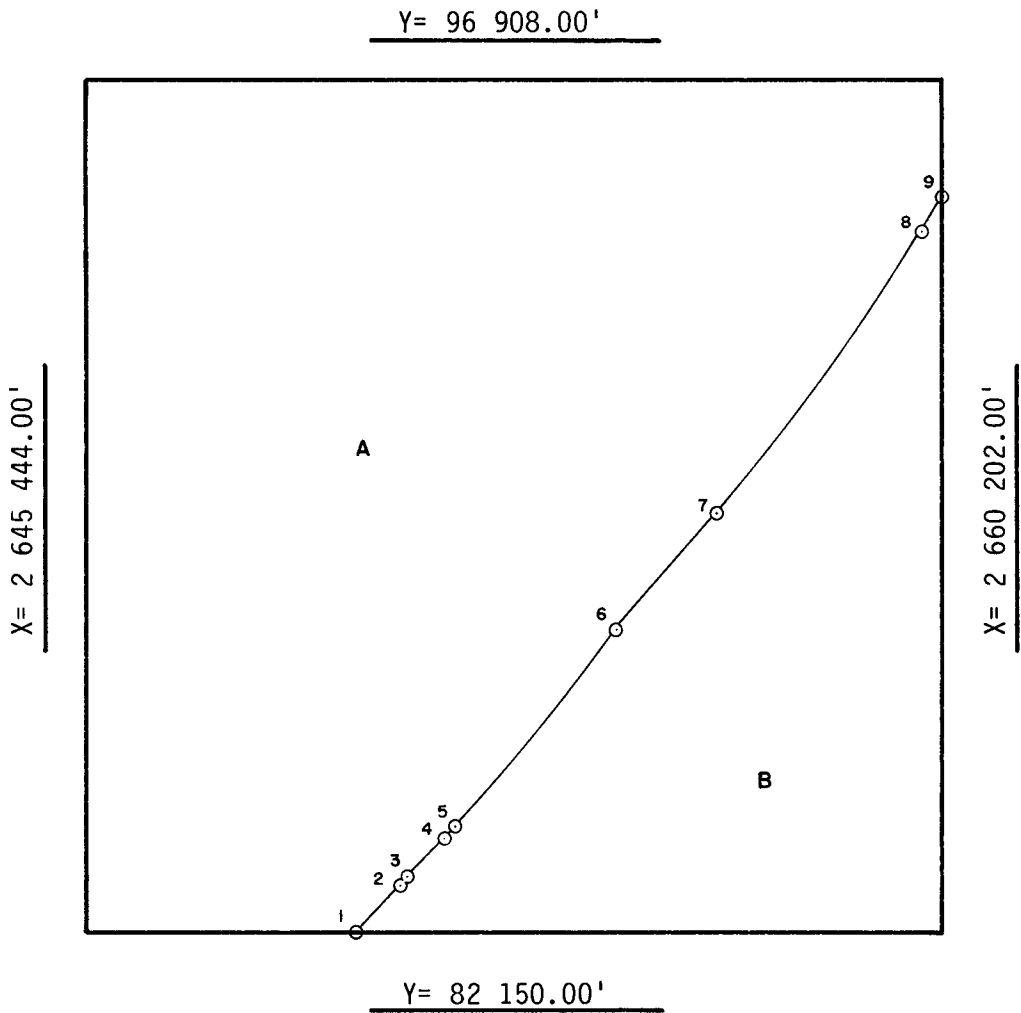

INTERSECTIONS

ARC CENTERS

	X	Y
1	2 650 130.81'	82 150.00'
2	2 650 887.08'	82 972.27'
3	2 651 006.48'	83 102.73'
4	2 651 649.79'	83 809.01'
5	2 651 812.63'	83 985.71'
6	2 654 601.52'	87 405.98'
7	2 656 299.32'	89 374.99'
8	2 659 850.14'	94 258.44'
9	2 660 202.00'	94 837.77'

	X	Y
*1-2	2 621 925'	105 355'
2-3	2 624 045'	107 660'
*3-4	2 624 045'	107 660'
*4-5	2 624 760'	108 445'
5-6	2 624 995'	108 700'
*6-7	2 625 550'	109 560'
7-8	2 628 680'	113 190'
*8-9	2 628 680'	113 190'

\*TANGENT SEGMENT

FEDERAL AREA B= 1377.69A STATE AREA \_\_\_\_\_ BG AREA A= 3622.28A DISPUTED AREA \_\_\_\_\_  
% \_\_\_\_\_ % \_\_\_\_\_ % \_\_\_\_\_ % \_\_\_\_\_

COMPUTATIONS BY JLD DATE 11-20-85 FOR THE DIRECTOR Telander FOR THE STATE \_\_\_\_\_  
DRAFTED BY QV DATE 5-30-86 DATE 5-16-87  
CHECKED BY JLD DATE 1-12-87 DATE \_\_\_\_\_