

UNITED STATES DEPARTMENT OF INTERIOR  
MINERALS MANAGEMENT SERVICE

SUPPLEMENTAL OFFICIAL  
OCS 8-G BLOCK DIAGRAM

SALE NO. \_\_\_\_\_  
☐ FED.-STATE SEAWARD BDY.  
RADIUS \_\_\_\_\_  
☒ 8-G BOUNDARY  
RADIUS 36 468.91'

South  
OPD NAME Pass Area  
OPD NO. LA Map 9  
BLOCK NO. 49  
OCS LEASE NO. \_\_\_\_\_  
STATE LEASE NO. \_\_\_\_\_

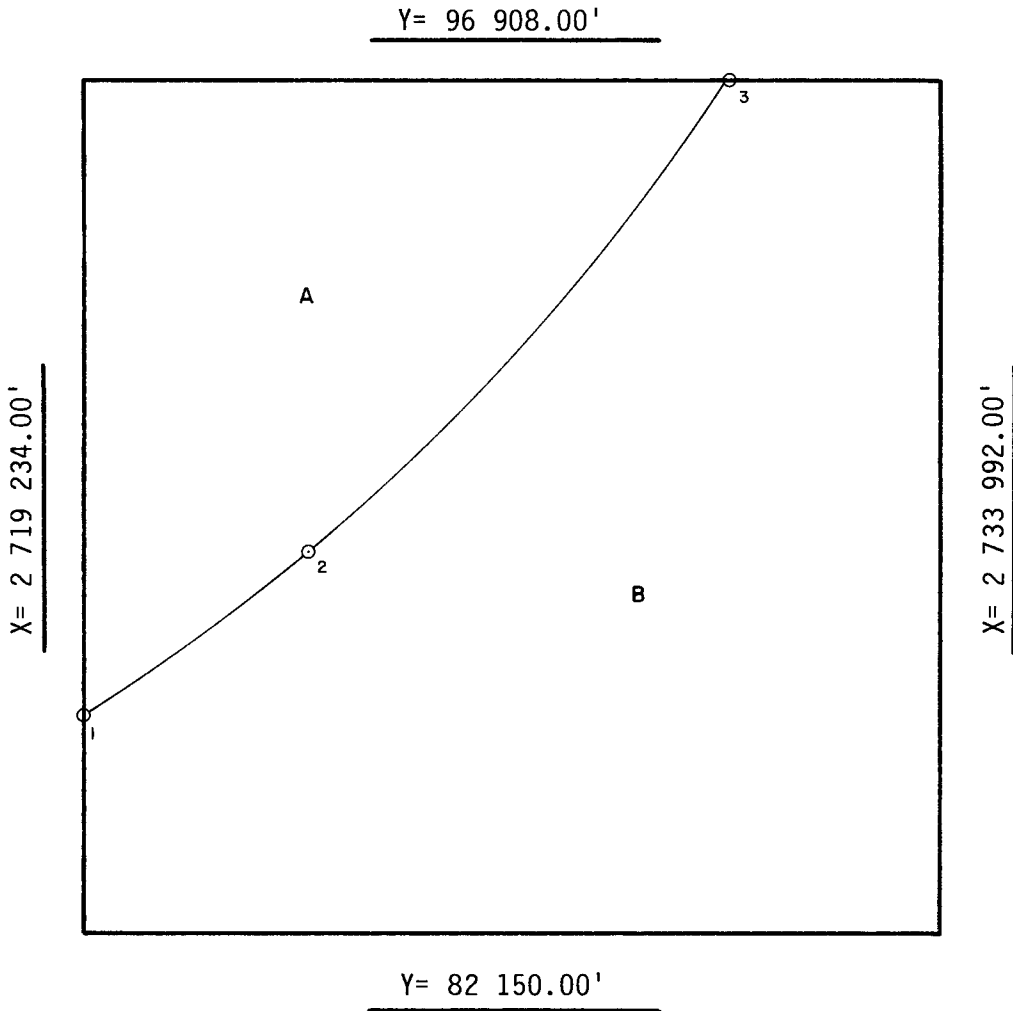

INTERSECTIONS

ARC CENTERS

	X	Y		X	Y
1	<u>2 719 234.00'</u>	<u>85 907.00'</u>	1-2	<u>2 699 695'</u>	<u>116 700'</u>
2	<u>2 723 101.77'</u>	<u>88 733.87'</u>	2-3	<u>2 699 815'</u>	<u>116 800'</u>
3	<u>2 730 381.15'</u>	<u>96 908.00'</u>			

FEDERAL AREA B= 3390.64A STATE AREA \_\_\_\_\_ BG AREA A= 1609.33A DISPUTED AREA \_\_\_\_\_  
% \_\_\_\_\_ % \_\_\_\_\_ % \_\_\_\_\_ % \_\_\_\_\_

COMPUTATIONS BY JF DC DATE 11-20-85 FOR THE DIRECTOR Toland & Gammohlen FOR THE STATE \_\_\_\_\_  
DRAFTED BY gl DATE 5-30-86 DATE 5-16-87 \_\_\_\_\_  
CHECKED BY TH DATE 1-12-87 DATE \_\_\_\_\_