

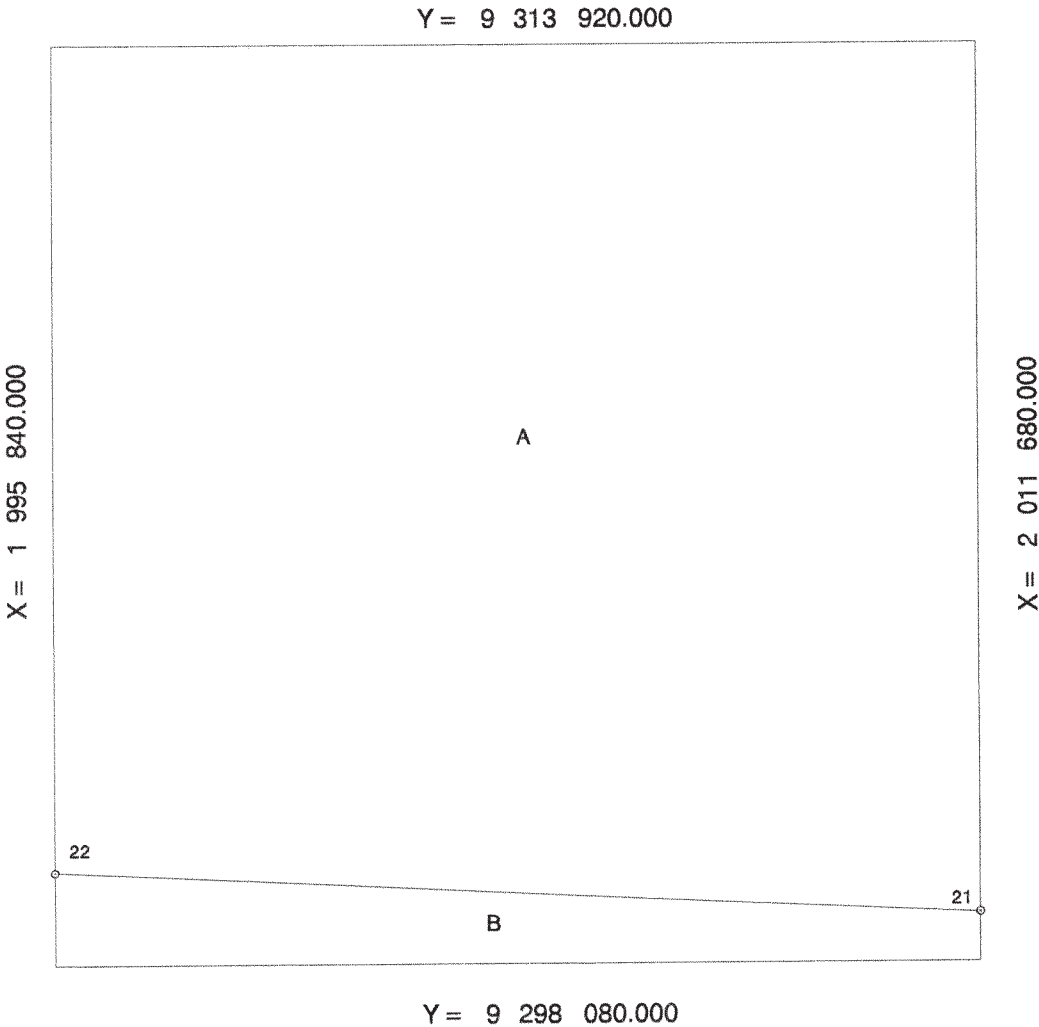

Supplemental Official OCS Block Diagram

OCS Planning Area Name Central Gulf of Mexico / NUS
Leasing Map / OPD Name Amery Terrace

Leasing Map/OPD Number NG15-09
Block Number 309
Datum NAD 27
Units Feet
Previous SOBD Signature Date 25-OCT-2000



Fed Area Beyond 200 NM A = 5317.940000 ac
Non-United States Area B = 442.060000 ac
Total Area 5760.000000 ac

Offshore Intersections		Contributing Baseline Points		Tangent Baseline End Points	
X	Y	X	Y	X	Y
21	2 011 680.000	9 298 920.310			
22	1 995 840.000	9 299 671.040			

Central Gulf of Mexico (A)
Non-US Jurisdiction (B)
U.S.-Mexico Continental Shelf Boundary

Douglas S. Vardig 01-JULY-2013
For the Director, BOEM Date

For the State Date