

Supplemental Official OCS Block Diagram

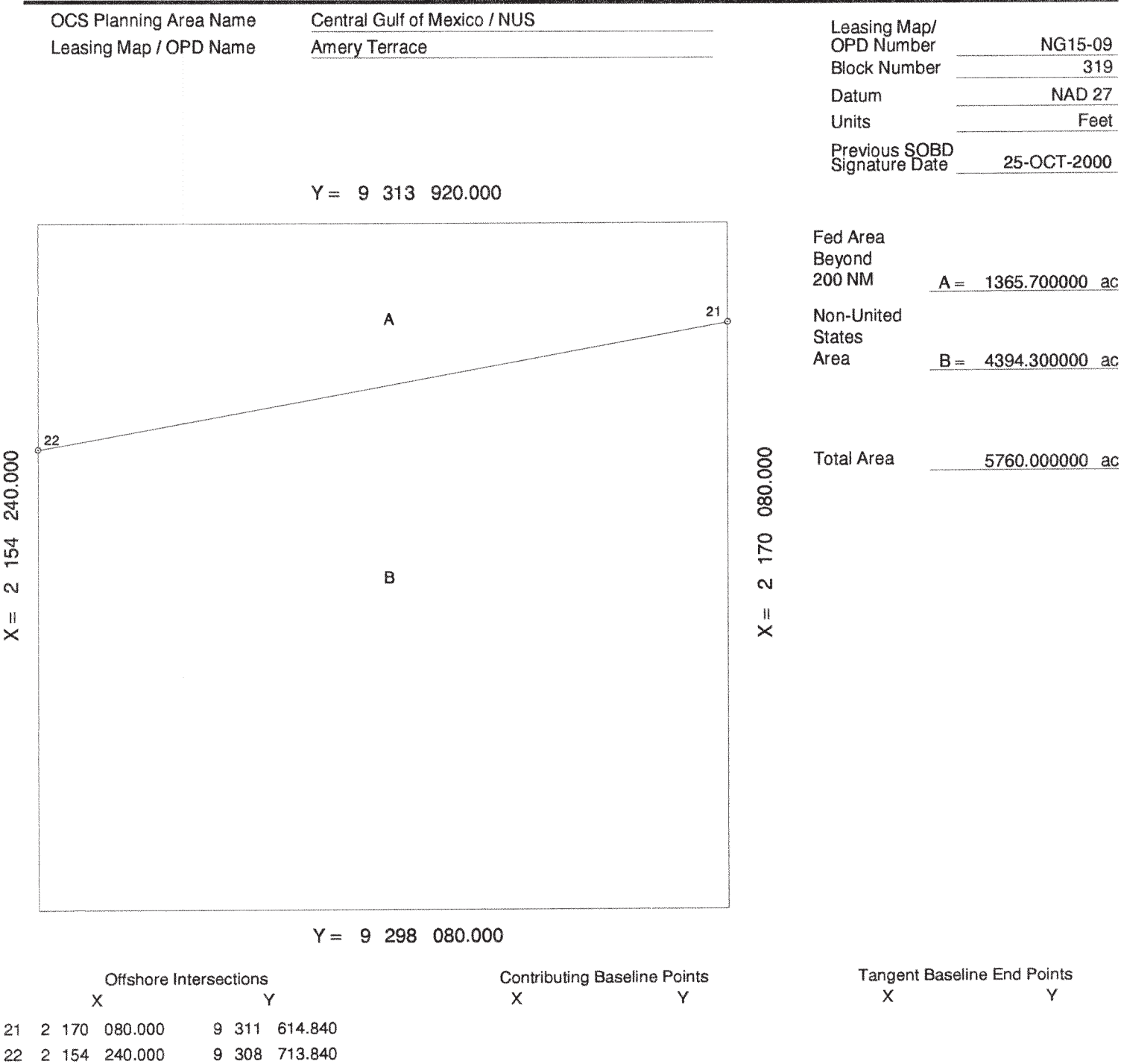

Y = 9 313 920.000

22

21

A

B

X = 2 154 240.000

X = 2 170 080.000

Y = 9 298 080.000

Offshore Intersections

X

Y

Contributing Baseline Points

X

Y

Tangent Baseline End Points

X

Y

21

2 170 080.000

9 311 614.840

22

2 154 240.000

9 308 713.840

Fed Area
Beyond
200 NM

A = 1365.700000 ac

Non-United
States
Area

B = 4394.300000 ac

Total Area

5760.000000 ac

Central Gulf of Mexico (A)

Non-US Jurisdiction (B)

U.S.-Mexico Continental Shelf Boundary

Douglas S. Vandegraft

01-JULY-2013

For the Director, BOEM

Date

For the State

Date