

Supplemental Official OCS Block Diagram

OCS Planning Area Name
Leasing Map / OPD Name

Central Gulf of Mexico / NUS
Amery Terrace

Leasing Map/
OPD Number
Block Number
Datum
Units
Previous SOBD
Signature Date

NG15-09
357
NAD 27
Feet
25-OCT-2000

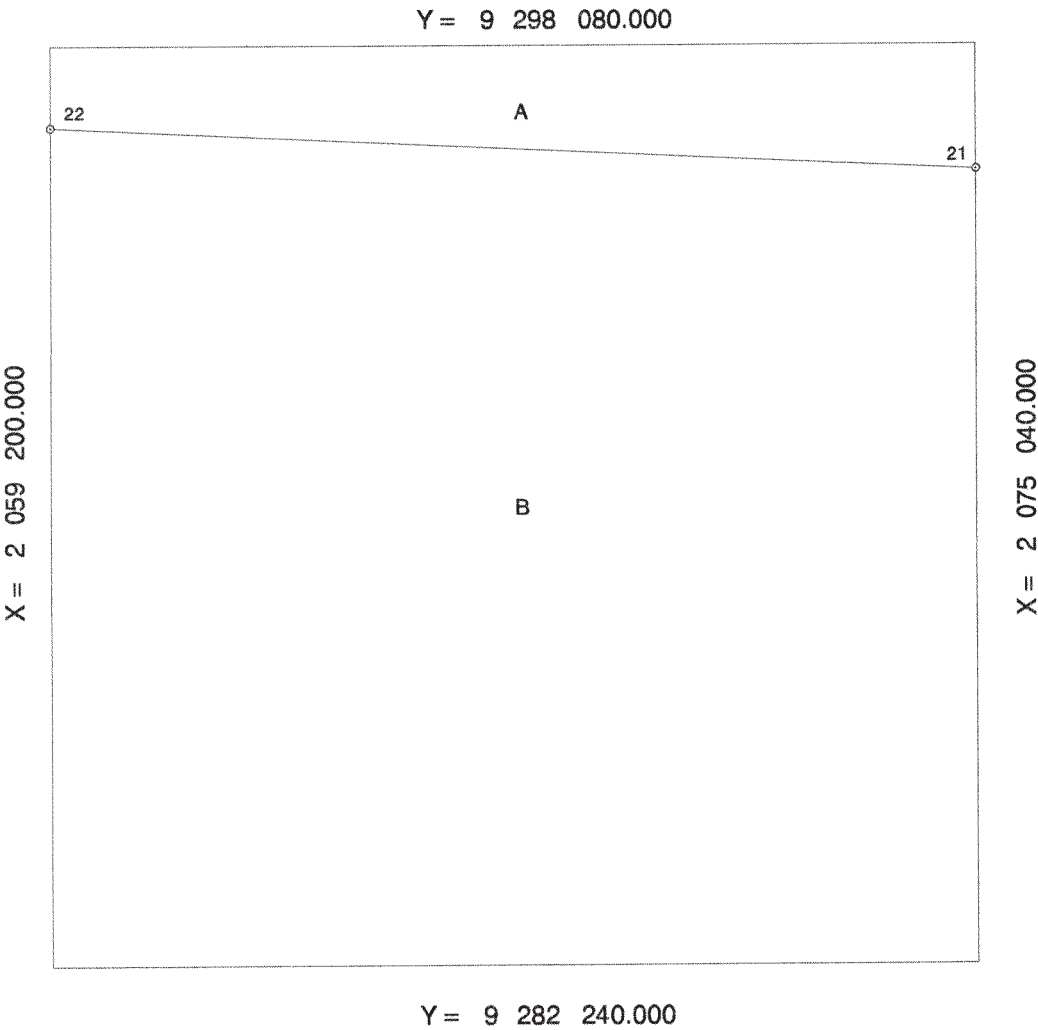

Fed Area
Beyond
200 NM
Non-United
States
Area
Total Area

A = 649.360000 ac
B = 5110.640000 ac
5760.000000 ac

Offshore Intersections		Contributing Baseline Points		Tangent Baseline End Points	
X	Y	X	Y	X	Y
21	2 075 040.000	9 295	919.990		
22	2 059 200.000	9 296	668.520		

Central Gulf of Mexico (A)
Non-US Jurisdiction (B)
U.S.-Mexico Continental Shelf Boundary

Douglas S. Vardag

01-JULY-2013

For the Director, BOEM

Date

For the State

Date