

UNITED STATES DEPARTMENT OF INTERIOR
MINERALS MANAGEMENT SERVICE

SUPPLEMENTAL OFFICIAL
OCS 8-G BLOCK DIAGRAM

SALE NO. _____
☐ FED.-STATE SEAWARD BDY.
RADIUS _____
☒ 8-G BOUNDARY
RADIUS 36 468.91'

OPD NAME Mobile
OPD NO. NH 16-4
BLOCK NO. 899
OCS LEASE NO. _____
STATE LEASE NO. _____

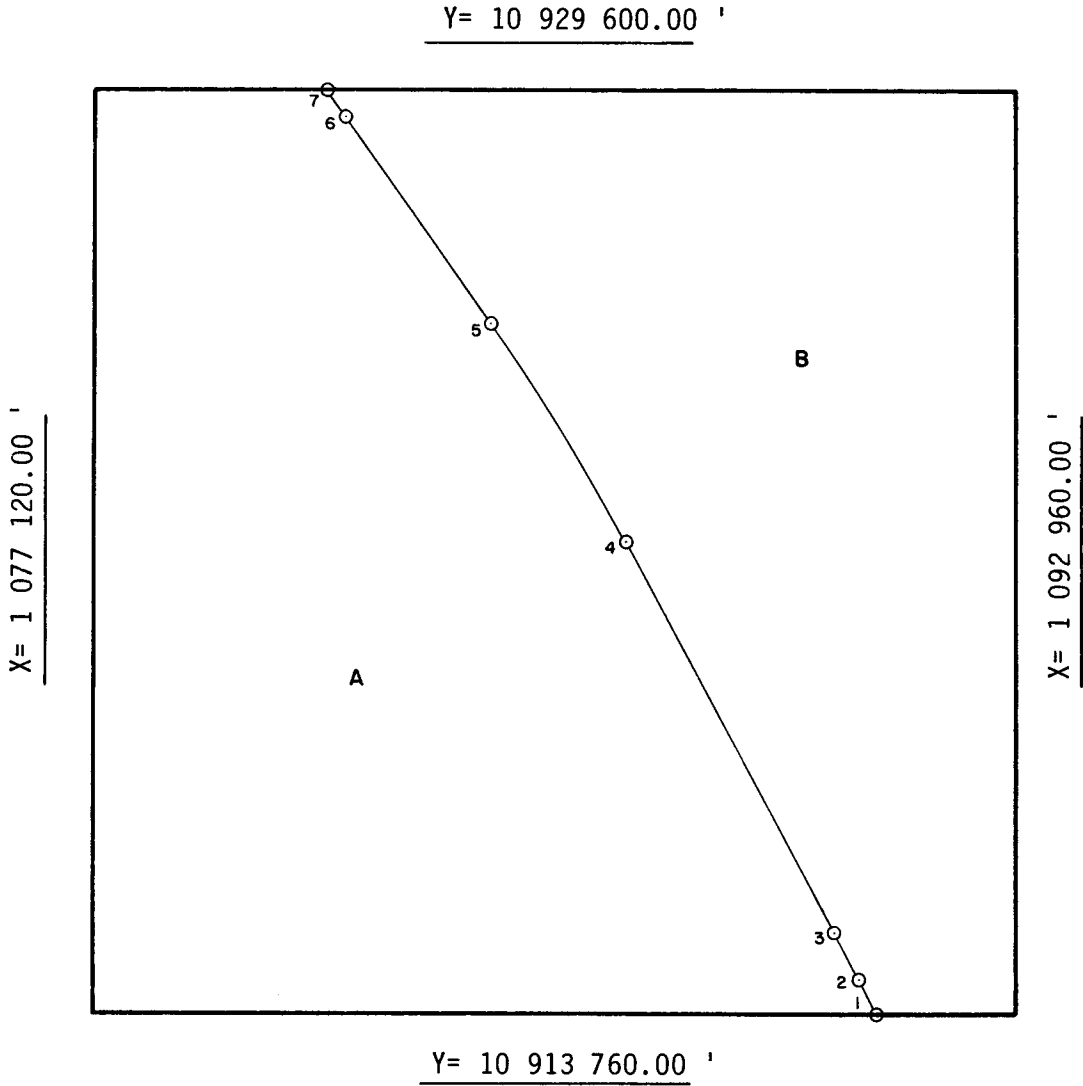

INTERSECTIONS

ARC CENTERS

	X	Y
1	1 090 542.50'	10 913 760.00'
2	1 090 262.86'	10 914 316.48'
3	1 089 842.56'	10 915 127.38'
4	1 086 264.06'	10 921 824.95'
5	1 083 943.27'	10 925 597.76'
6	1 081 445.84'	10 929 154.03'
7	1 081 127.62'	10 929 600.00'

	X	Y
*1-2	1 059 103.75'	10 895 102.22'
2-3	1 057 677.01'	10 897 941.38'
*3-4	1 057 677.01'	10 897 941.38'
4-5	1 054 098.51'	10 904 638.95'
*5-6	1 054 098.51'	10 904 638.95'
6-7	1 051 601.08'	10 908 195.22'

*TANGENT SEGMENT

FEDERAL AREA B= 2474.65A STATE AREA _____ 8G AREA A= 3285.35A DISPUTED AREA _____
% _____ % _____ % _____ % _____

COMPUTATIONS BY DLB DATE 12/9/85 FOR THE DIRECTOR Island of Guam FOR THE STATE _____
DRAFTED BY JV DATE 10-23-86 DATE 5-16-87 DATE _____
CHECKED BY ALD DATE 12/9/86 DATE _____