

Supplemental Official OCS Block Diagram

OCS Planning Area Name Eastern Gulf Of Mexico
Leasing Map / OPD Name Gainesville

Leasing Map/
OPD Number NH17-07
Block Number 1
Datum NAD 27

☒ State Seaward Boundary Radius 54 684.930
☐ Limit of '8(g) Zone' Radius

☒ Feet
☐ Meters

☒ Previous SOBD
Signature Date 02-JUN-83

Y= 10 882 080.000

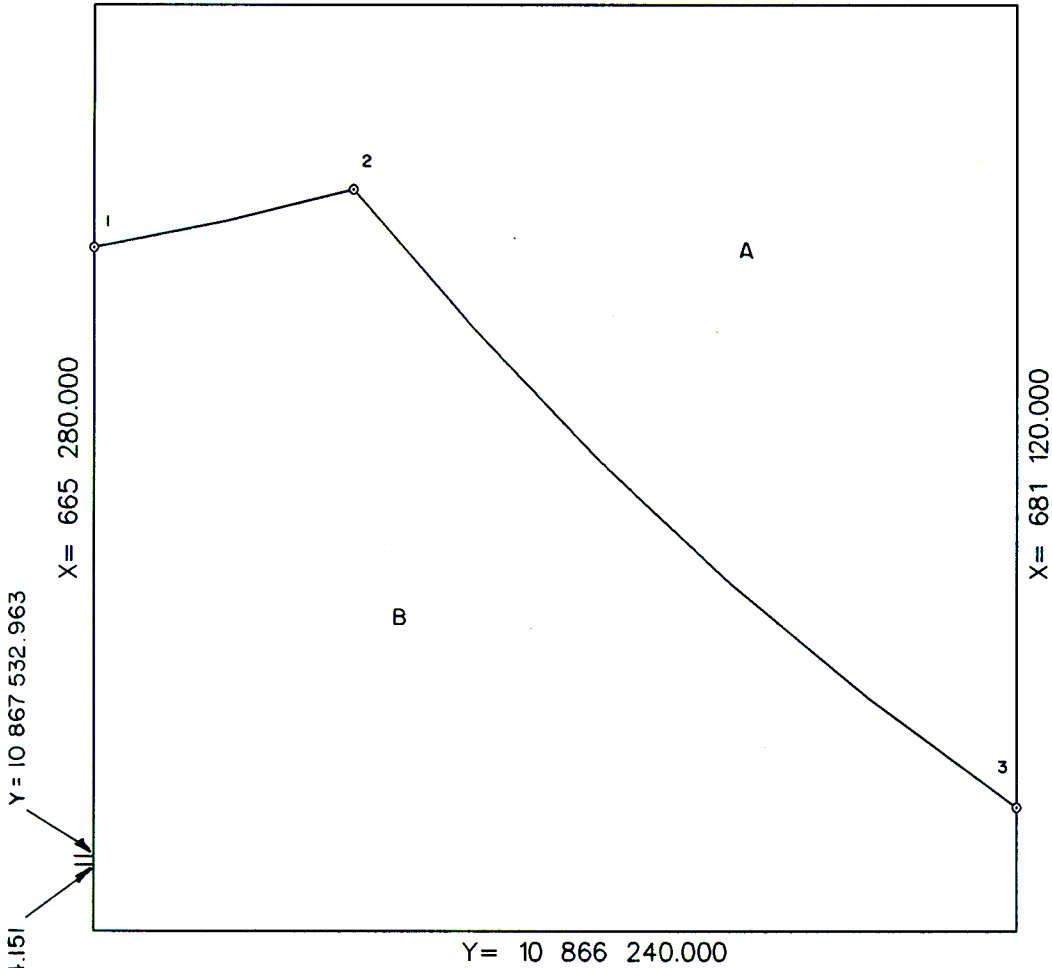

State
Area A = 2725.793387A

Federal
8(g) Area B = 3034.206613A

Boundary
Disputed

Federal
Non-8(g)
Area

8(g)
Disputed

Federal
Withdrawn
Area

Federal
Deferred
Area

Total Area 5760.000000A

Offshore Intersections

Contributing Baseline Points

	X	Y		X	Y
1	665 280.000	10 877 902.776	1-2	655 546.088	10 931 714.415
2	669 712.152	10 878 896.196	2-3	712 177.470	10 913 351.070
3	681 120.000	10 868 341.347			

John H. Hunsaker 03/01/99
For the Director, MMS Date

For the State Date