

Supplemental Official OCS Block Diagram

OCS Planning Area Name	Straits of Florida	Leasing Map/ OPD Number	NG17-02
Leasing Map / OPD Name	Ft. Pierce	Block Number	6838
Submerged Lands Act Boundary Radius	5556.000	Datum	NAD 83/WGS 84
		Units	Meters
		Previous SOBD Signature Date	13-MAR-1997

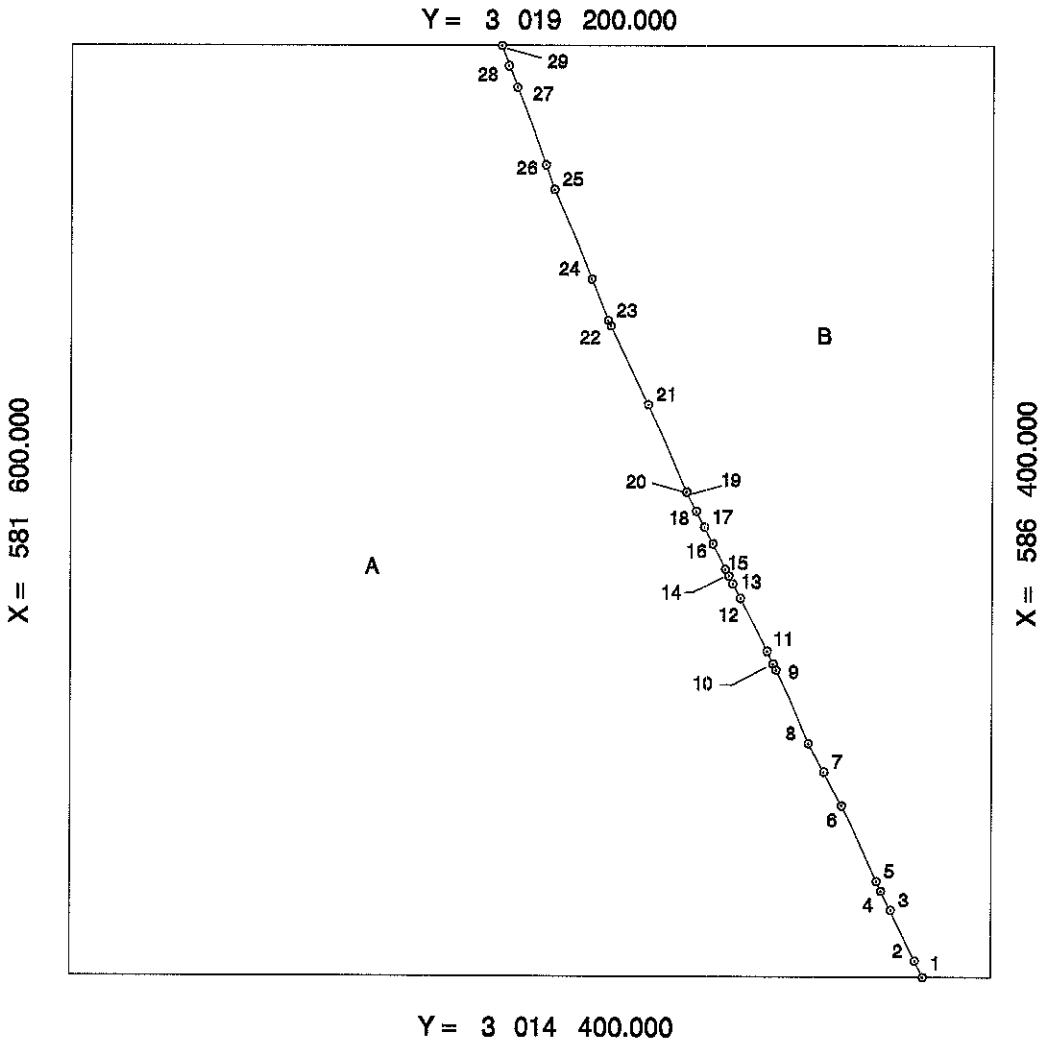

State Area	A = 1579.862753 ha
Federal 8(g) Area	B = 724.137247 ha
Total Area	2304.000000 ha

Offshore Intersections				Contributing Baseline Points				Tangent Baseline End Points			
	X	Y			X	Y		X	Y		
1	586 046.268	3 014 400.000	1 - 2	581 026.574	3 012 018.444						
2	586 004.597	3 014 485.917	2 - 3	580 942.117	3 012 196.718						
3	585 877.490	3 014 748.430	3 - 4	580 925.400	3 012 229.314						
4	585 826.215	3 014 846.785	4 - 5	580 775.384	3 012 531.996						
5	585 802.802	3 014 897.203	5 - 6	580 686.269	3 012 731.510						
6	585 618.869	3 015 288.577	6 - 7	580 661.593	3 012 779.683						
7	585 526.995	3 015 462.405	7 - 8	580 641.812	3 012 815.875						
8	585 444.361	3 015 609.557	8 - 9	580 301.995	3 013 505.939						
9	585 274.324	3 015 984.867	9 - 10	580 261.336	3 013 589.227						
10	585 259.192	3 016 016.276	10 - 11	580 236.626	3 013 640.784						
11	585 228.156	3 016 080.819	11 - 12	580 221.021	3 013 672.969						
12	585 088.080	3 016 352.685	12 - 13	580 184.534	3 013 740.334						
13	585 047.993	3 016 426.577	13 - 14	580 095.663	3 013 907.934						
14	585 027.078	3 016 467.287	14 - 15	580 087.390	3 013 923.938						
15	585 009.590	3 016 500.968	15 - 16	580 018.553	3 014 059.926						
16	584 943.388	3 016 631.917	16 - 17	579 973.904	3 014 147.291						
17	584 899.914	3 016 717.031	17 - 18	579 957.555	3 014 178.877						
18	584 856.638	3 016 799.588	18 - 19	579 905.569	3 014 278.466						
19	584 805.337	3 016 897.895	19 - 20	579 742.858	3 014 608.694						
20	584 804.924	3 016 898.808	20 - 21	579 634.290	3 014 865.663						

Supplemental Official OCS Block Diagram

OCS Planning Area Name	Straits of Florida	Leasing Map/ OPD Number	NG17-02
Leasing Map / OPD Name	Ft. Pierce	Block Number	6838

Offshore Intersections				Contributing Baseline Points				Tangent Baseline End Points	
	X		Y		X		Y	X	Y
21	584	603.785	3 017	350.266	21 -22	579	499.048	3 015	156.914
22	584	406.858	3 017	761.244	22 -23	579	407.644	3 015	336.993
23	584	393.614	3 017	788.368	23 -24	579	206.141	3 015	798.579
24	584	306.660	3 018	001.723	24 -25	579	101.322	3 016	059.149
25	584	111.507	3 018	460.645	25 -26	578	850.801	3 016	673.438
26	584	066.482	3 018	588.069	26 -27	578	799.108	3 016	820.610
27	583	916.511	3 018	984.246	27 -28	578	734.604	3 016	980.007
28	583	872.211	3 019	095.221	28 -29	578	605.024	3 017	327.206
29	583	835.873	3 019	200.000					

10/01/07

For the Director, MMS

Date

For the State

Date