

Supplemental Official OCS Block Diagram

| | | | |
|-------------------------------------|--------------------|---------------------------------|---------------|
| OCS Planning Area Name | Straits of Florida | Leasing Map/ OPD Number | NG17-06 |
| Leasing Map / OPD Name | Bahamas | Block Number | 6402 |
| Submerged Lands Act Boundary Radius | 5556.000 | Datum | NAD 83/WGS 84 |
| | | Units | Meters |
| | | Previous SOBD Signature Date | 13-MAR-1997 |

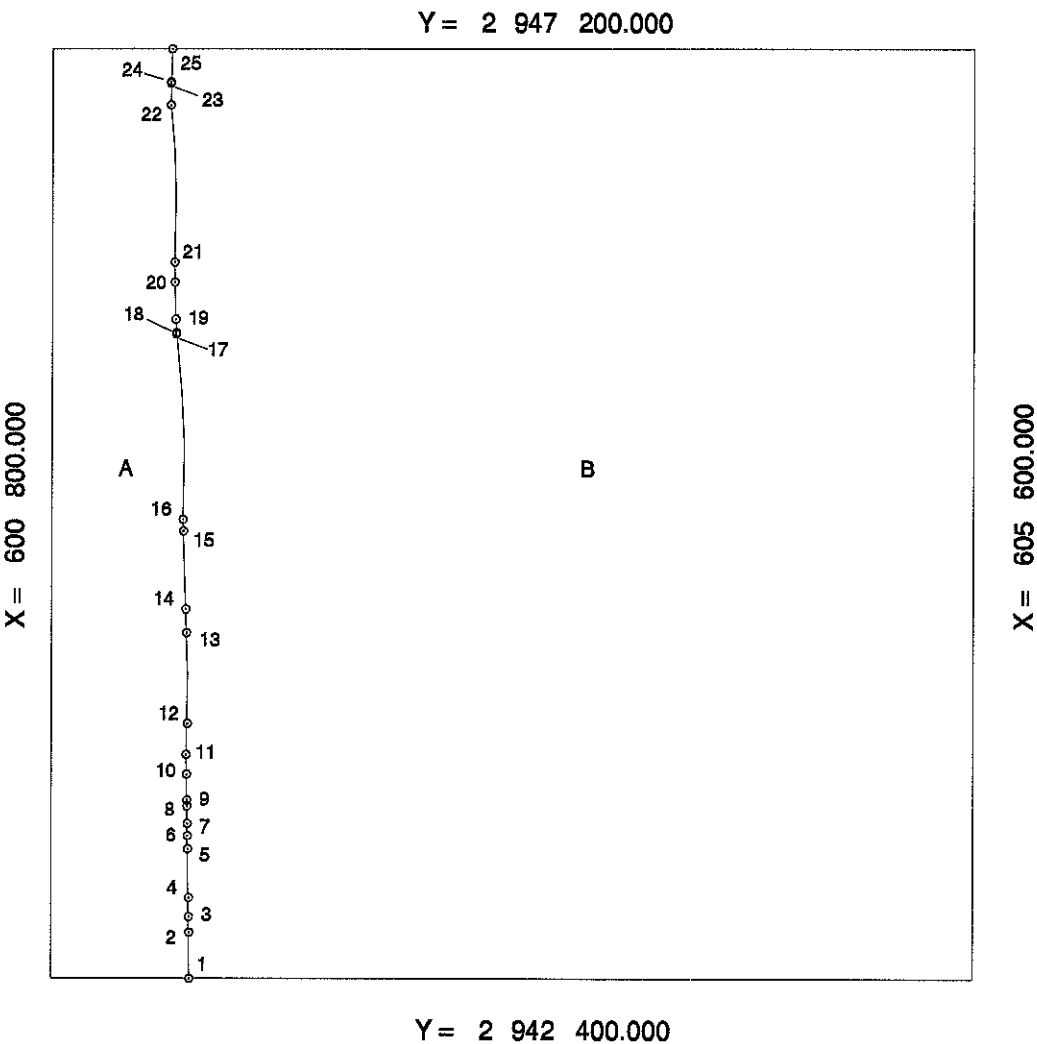

| | |
|----------------------|--------------------|
| State Area | A = 325.693027 ha |
| Federal 8(g) Area | B = 1978.306973 ha |
| Total Area | 2304.000000 ha |

| Offshore Intersections | | | | Contributing Baseline Points | | | | Tangent Baseline End Points | |
|------------------------|-------------|---------------|---------|------------------------------|---------------|--|--|-----------------------------|---|
| | X | Y | | X | Y | | | X | Y |
| 1 | 601 519.326 | 2 942 400.000 | 1 - 2 | 595 963.901 | 2 942 479.940 | | | | |
| 2 | 601 517.596 | 2 942 639.948 | 2 - 3 | 595 961.783 | 2 942 594.421 | | | | |
| 3 | 601 516.344 | 2 942 720.850 | 3 - 4 | 595 960.365 | 2 942 736.001 | | | | |
| 4 | 601 515.740 | 2 942 819.321 | 4 - 5 | 595 959.755 | 2 942 832.140 | | | | |
| 5 | 601 510.587 | 2 943 071.726 | 5 - 6 | 595 955.079 | 2 942 997.779 | | | | |
| 6 | 601 509.243 | 2 943 140.619 | 6 - 7 | 595 953.515 | 2 943 085.597 | | | | |
| 7 | 601 508.273 | 2 943 203.086 | 7 - 8 | 595 952.587 | 2 943 143.983 | | | | |
| 8 | 601 506.577 | 2 943 293.429 | 8 - 9 | 595 950.770 | 2 943 247.087 | | | | |
| 9 | 601 506.233 | 2 943 324.332 | 9 - 10 | 595 950.254 | 2 943 309.060 | | | | |
| 10 | 601 504.237 | 2 943 458.773 | 10 - 11 | 595 948.591 | 2 943 396.014 | | | | |
| 11 | 601 502.125 | 2 943 561.531 | 11 - 12 | 595 953.061 | 2 943 839.064 | | | | |
| 12 | 601 507.829 | 2 943 722.070 | 12 - 13 | 595 954.277 | 2 943 886.980 | | | | |
| 13 | 601 502.044 | 2 944 189.324 | 13 - 14 | 595 947.055 | 2 944 083.363 | | | | |
| 14 | 601 498.385 | 2 944 311.112 | 14 - 15 | 595 942.416 | 2 944 329.634 | | | | |
| 15 | 601 485.280 | 2 944 711.470 | 15 - 16 | 595 931.570 | 2 944 551.954 | | | | |
| 16 | 601 483.292 | 2 944 769.935 | 16 - 17 | 595 933.423 | 2 945 030.870 | | | | |
| 17 | 601 445.301 | 2 945 729.681 | 17 - 18 | 595 894.601 | 2 945 487.059 | | | | |
| 18 | 601 445.044 | 2 945 735.490 | 18 - 19 | 595 892.376 | 2 945 543.101 | | | | |
| 19 | 601 442.140 | 2 945 806.257 | 19 - 20 | 595 886.497 | 2 945 743.311 | | | | |
| 20 | 601 436.618 | 2 945 998.832 | 20 - 21 | 595 880.774 | 2 946 040.445 | | | | |

Supplemental Official OCS Block Diagram

| | | | | | | | | | | | | | | |
|------------------------|---------|--------------------|-----|---------|------------------------------|----------------------------|---------|---------|-----|-----------------------------|--|---|--|--|
| OCS Planning Area Name | | Straits of Florida | | | | Leasing Map/ OPD Number | | NG17-06 | | | | | | |
| Leasing Map / OPD Name | | Bahamas | | | | Block Number | | 6402 | | | | | | |
| Offshore Intersections | | | | | Contributing Baseline Points | | | | | Tangent Baseline End Points | | | | |
| X | | Y | | | | X | | Y | | X | | Y | | |
| 601 | 436.405 | 2 | 946 | 104.470 | 21 -22 | 595 | 886.688 | 2 | 946 | 368.622 | | | | |
| 601 | 415.759 | 2 | 946 | 914.979 | 22 -23 | 595 | 859.811 | 2 | 946 | 938.929 | | | | |
| 601 | 415.134 | 2 | 947 | 025.676 | 23 -24 | 595 | 859.198 | 2 | 946 | 998.959 | | | | |
| 601 | 415.103 | 2 | 947 | 031.443 | 24 -25 | 595 | 866.136 | 2 | 947 | 310.908 | | | | |
| 601 | 421.029 | 2 | 947 | 200.000 | | | | | | | | | | |

Stephen G. Kopach

For the Director, MMS

11/01/2007
Date

For the State

Date