

Supplemental Official OCS Block Diagram

|                             |                |                                 |               |
|-----------------------------|----------------|---------------------------------|---------------|
| OCS Planning Area Name      | South Atlantic | Leasing Map/<br>OPD Number      | NH17-05       |
| Leasing Map / OPD Name      | Jacksonville   | Block Number                    | 7066          |
| Limit of '8(g) Zone' Radius | 11 112.000     | Datum                           | NAD 83/WGS 84 |
|                             |                | Units                           | Meters        |
|                             |                | Previous SOBD<br>Signature Date | 13-MAR-1997   |

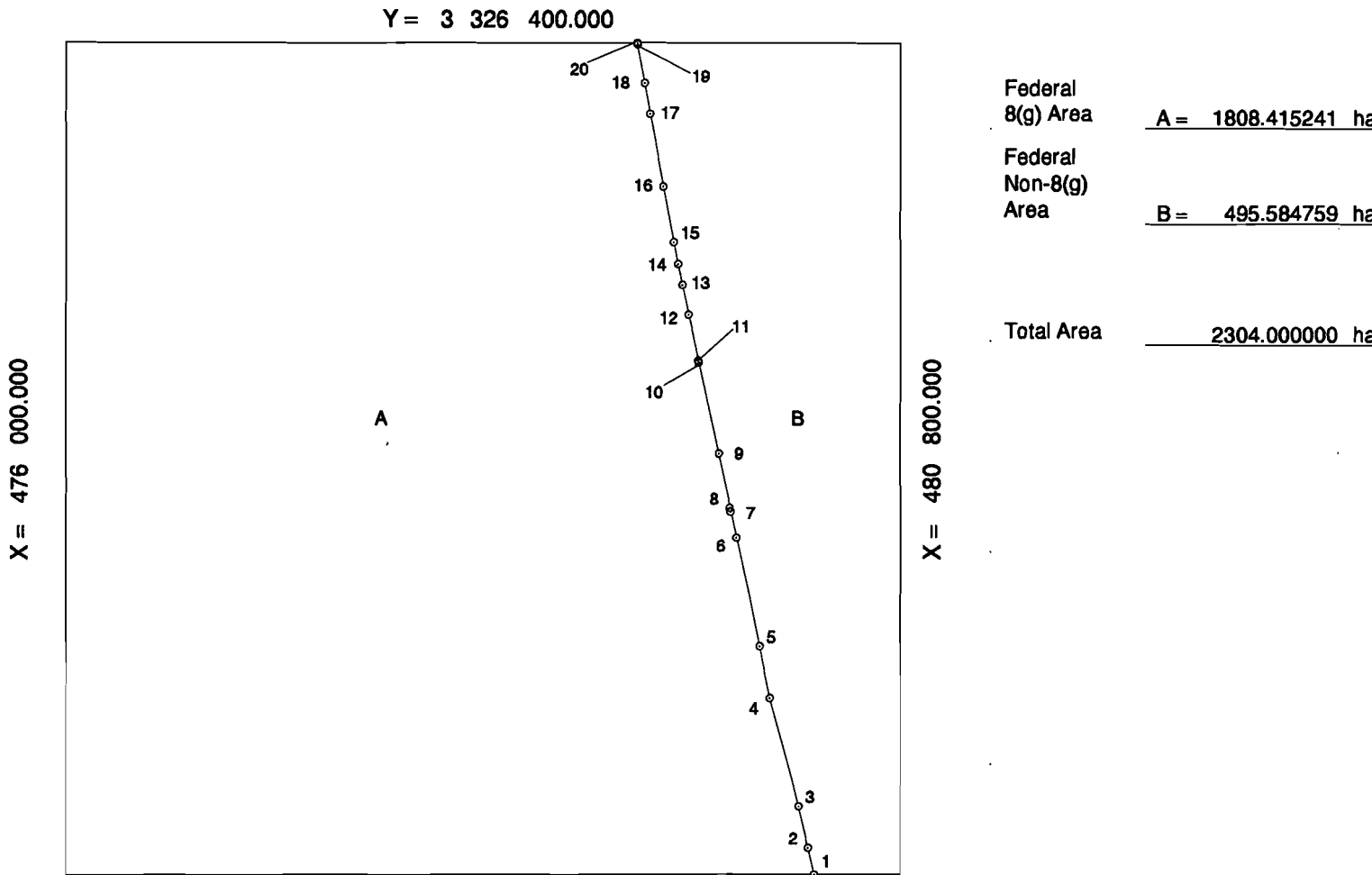

Y = 3 321 600.000

| Offshore Intersections |             |               | Contributing Baseline Points |             |               | Tangent Baseline End Points |   |   |
|------------------------|-------------|---------------|------------------------------|-------------|---------------|-----------------------------|---|---|
|                        | X           | Y             |                              | X           | Y             |                             | X | Y |
| 1                      | 480 303.774 | 3 321 600.000 | 1 - 2                        | 469 446.199 | 3 319 235.763 |                             |   |   |
| 2                      | 480 269.105 | 3 321 753.947 | 2 - 3                        | 469 420.195 | 3 319 350.263 |                             |   |   |
| 3                      | 480 213.263 | 3 321 993.409 | 3 - 4                        | 469 389.683 | 3 319 478.125 |                             |   |   |
| 4                      | 480 048.556 | 3 322 618.979 | 4 - 5                        | 469 127.986 | 3 320 565.278 |                             |   |   |
| 5                      | 479 988.492 | 3 322 916.013 | 5 - 6                        | 469 057.240 | 3 320 919.948 |                             |   |   |
| 6                      | 479 855.336 | 3 323 542.481 | 6 - 7                        | 468 995.757 | 3 321 187.465 |                             |   |   |
| 7                      | 479 821.854 | 3 323 691.894 | 7 - 8                        | 468 935.957 | 3 321 461.695 |                             |   |   |
| 8                      | 479 816.998 | 3 323 715.466 | 8 - 9                        | 468 887.886 | 3 321 707.719 |                             |   |   |
| 9                      | 479 753.960 | 3 324 032.578 | 9 - 10                       | 468 851.752 | 3 321 883.533 |                             |   |   |
| 10                     | 479 637.379 | 3 324 556.882 | 10 - 11                      | 468 822.477 | 3 322 004.542 |                             |   |   |
| 11                     | 479 634.870 | 3 324 567.491 | 11 - 12                      | 468 734.264 | 3 322 410.331 |                             |   |   |
| 12                     | 479 578.605 | 3 324 834.546 | 12 - 13                      | 468 681.293 | 3 322 660.807 |                             |   |   |
| 13                     | 479 542.926 | 3 325 006.330 | 13 - 14                      | 468 656.114 | 3 322 780.600 |                             |   |   |
| 14                     | 479 517.783 | 3 325 125.955 | 14 - 15                      | 468 601.864 | 3 323 047.673 |                             |   |   |
| 15                     | 479 493.063 | 3 325 251.834 | 15 - 16                      | 468 541.188 | 3 323 372.213 |                             |   |   |
| 16                     | 479 433.472 | 3 325 571.009 | 16 - 17                      | 468 477.002 | 3 323 718.357 |                             |   |   |
| 17                     | 479 354.330 | 3 325 989.983 | 17 - 18                      | 468 383.666 | 3 324 223.325 |                             |   |   |
| 18                     | 479 324.072 | 3 326 168.589 | 18 - 19                      | 468 362.641 | 3 324 345.524 |                             |   |   |
| 19                     | 479 284.554 | 3 326 392.075 | 19 - 20                      | 468 351.072 | 3 324 408.259 |                             |   |   |
| 20                     | 479 283.113 | 3 326 400.000 |                              |             |               |                             |   |   |

*John G. Kyra* 11/01/07  
For the Director, MMS Date

For the State Date