

Supplemental Official OCS Block Diagram

OCS Planning Area Name South Atlantic
Leasing Map / OPD Name Orlando
Submerged Lands Act Boundary Radius 5556.000

Leasing Map/
OPD Number NH17-11
Block Number 6880
Datum NAD 83/WGS 84
Units Meters
Previous SOBD
Signature Date 13-MAR-1997

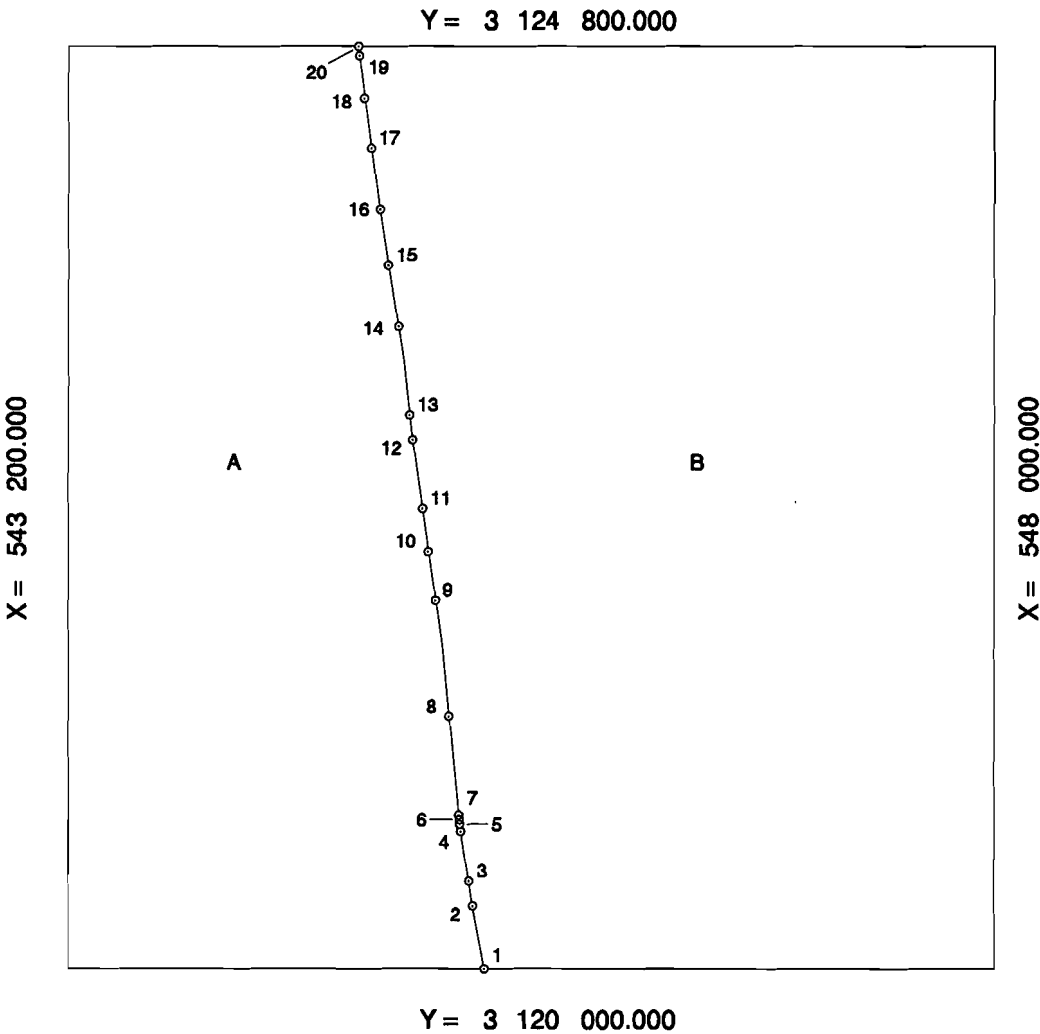

State
Area A = 874.732570 ha

Federal
8(g) Area B = 1429.267430 ha

Total Area 2304.000000 ha

Offshore Intersections			Contributing Baseline Points			Tangent Baseline End Points		
	X	Y		X	Y		X	Y
1	545	351.668	3 120 000.000	1 - 2	539 865.288	3 119 123.207		
2	545	289.561	3 120 325.868	2 - 3	539 786.781	3 119 558.702		
3	545	270.006	3 120 455.014	3 - 4	539 768.438	3 119 679.204		
4	545	227.962	3 120 710.095	4 - 5	539 720.815	3 119 974.928		
5	545	222.755	3 120 748.101	5 - 6	539 697.012	3 120 169.046		
6	545	220.153	3 120 772.408	6 - 7	539 681.887	3 120 328.852		
7	545	218.186	3 120 796.327	7 - 8	539 670.000	3 120 501.757		
8	545	166.546	3 121 312.382	8 - 9	539 621.317	3 120 966.598		
9	545	095.411	3 121 917.087	9 - 10	539 579.062	3 121 254.495		
10	545	059.068	3 122 170.285	10 - 11	539 537.884	3 121 549.266		
11	545	029.283	3 122 394.058	11 - 12	539 507.790	3 121 775.793		
12	544	977.499	3 122 751.202	12 - 13	539 450.902	3 122 180.356		
13	544	962.637	3 122 880.292	13 - 14	539 426.546	3 122 410.367		
14	544	904.092	3 123 340.755	14 - 15	539 398.536	3 122 593.771		
15	544	850.950	3 123 661.626	15 - 16	539 334.964	3 122 996.020		
16	544	808.199	3 123 951.444	16 - 17	539 286.166	3 123 338.021		
17	544	763.255	3 124 271.099	17 - 18	539 244.912	3 123 625.321		
18	544	726.383	3 124 532.303	18 - 19	539 198.494	3 123 974.106		
19	544	699.938	3 124 750.796	19 - 20	539 165.431	3 124 262.569		
20	544	695.377	3 124 800.000					

Steph G. Kyras 11/01/07
For the Director, MMS Date

For the State Date