

Composite Block Diagram

OCS Planning Area Name	Southern California	Leasing Map/OPD Number	NI11-07
Leasing Map / OPD Name	Long Beach	Block Number	6489
Limit of `8(g) Zone` Radius	11 112.000	Datum	NAD 83/WGS 84
Other Boundary Radius	11 112.000	Units	Meters
		Previous CBD Signature Date	

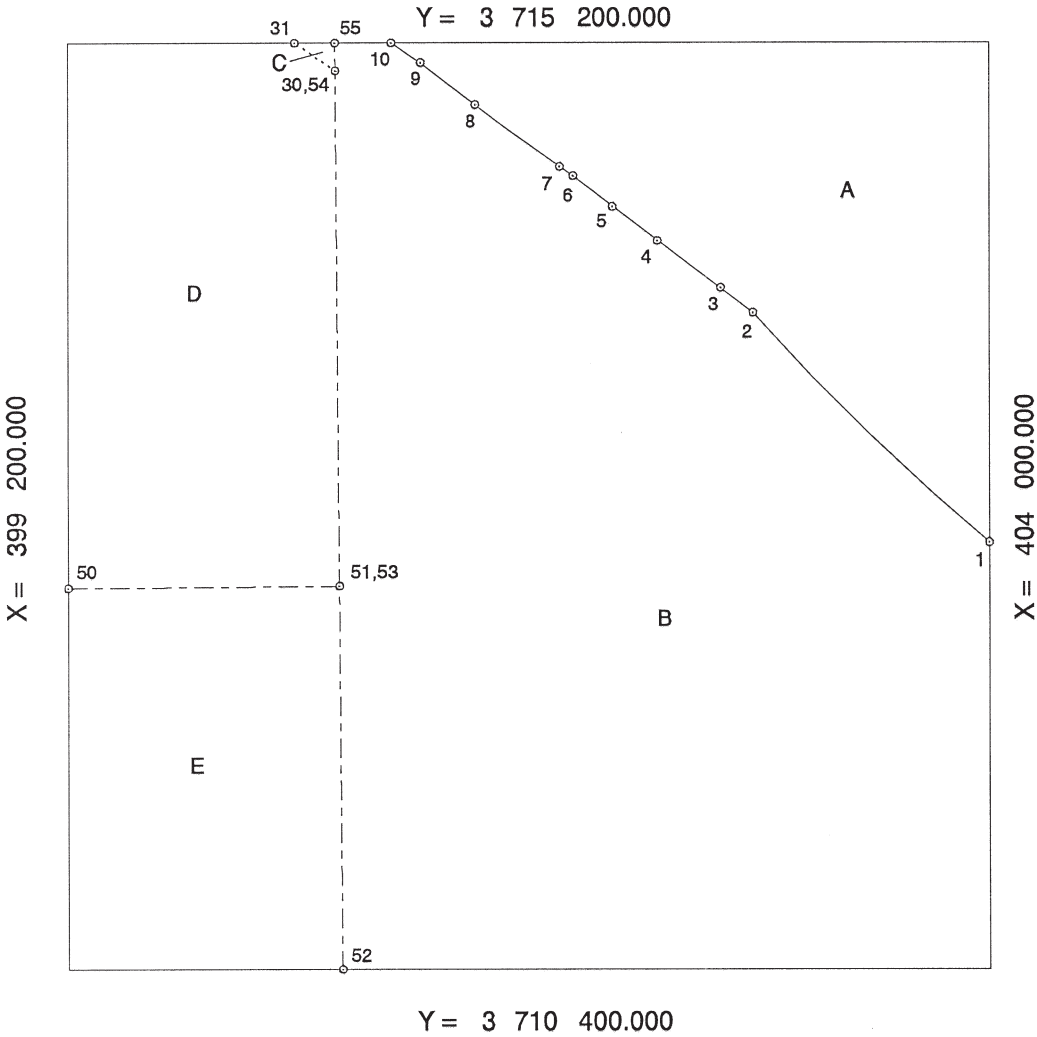

Federal 8(g) Area	A =	379.090858	ha
	B =	1246.590315	ha
Federal Non-8(g) Area	C =	1.514500	ha #
	D =	394.341120	ha #
	E =	282.463207	ha #
Total Area		2304.000000	ha

Offshore Intersections				Contributing Baseline Points				Tangent Baseline End Points			
	X		Y		X		Y		X		Y
1	404 000.000	3 712 614.137		1 - 2	411 081.903	3 721 177.033					
2	402 770.004	3 713 802.152		* 2 - 3	409 698.409	3 722 490.975		*	409 306.567	3 722 794.979	
3	402 601.979	3 713 932.511		* 3 - 4	409 306.567	3 722 794.979		*	408 867.022	3 723 119.165	
4	402 271.298	3 714 176.405		4 - 5	408 867.022	3 723 119.165					
5	402 036.529	3 714 354.411		* 5 - 6	408 867.022	3 723 119.165		*	408 412.082	3 723 473.706	
6	401 831.297	3 714 514.351		* 6 - 7	408 412.082	3 723 473.706		*	408 081.937	3 723 702.019	
7	401 761.535	3 714 562.596		7 - 8	408 081.937	3 723 702.019					
8	401 322.880	3 714 882.059		* 8 - 9	408 081.937	3 723 702.019		*	407 345.198	3 724 266.609	
9	401 039.806	3 715 098.989		9 - 10	407 114.168	3 724 403.755					
10	400 887.818	3 715 200.000									
30	400 597.084	3 715 056.464		30 - 31	406 854.676	3 724 235.635					
31	400 386.767	3 715 200.000									
50	399 200.000	3 712 379.667									
51	400 616.083	3 712 389.747									
52	400 630.278	3 710 400.000									
53	400 616.083	3 712 389.747									
54	400 597.084	3 715 056.464									

-----

-----

-----

#

\*

Lease Limit

Limit of `8(g) Zone` (NAD83)

Limit of `8(g) Zone` (NAD27)

Federal Leased Area

Tangent Segment

Composite Block Diagram

OCS Planning Area Name	Southern California	Leasing Map/ OPD Number	NI11-07
Leasing Map / OPD Name	Long Beach	Block Number	6489

Offshore Intersections				Contributing Baseline Points		Tangent Baseline End Points	
X		Y		X	Y	X	Y
55	400	596.069	3	715	200.000		

Doyle S. Vaduz

01-JUNE-2011

For the Director, BOEMRE

Date

For the State

Date