

Supplemental Official OCS Block Diagram

OCS Planning Area Name Washington-Oregon  
Leasing Map / OPD Name Coos Bay

Leasing Map/  
OPD Number NK10-01  
Block Number 6380  
Datum NAD 83/WGS 84  
☐ Previous SOBD  
Signature Date \_\_\_\_\_

☐ State Seaward Boundary Radius \_\_\_\_\_  
☒ Limit of '8(g) Zone' Radius 11 112.000

☐ Feet  
☒ Meters

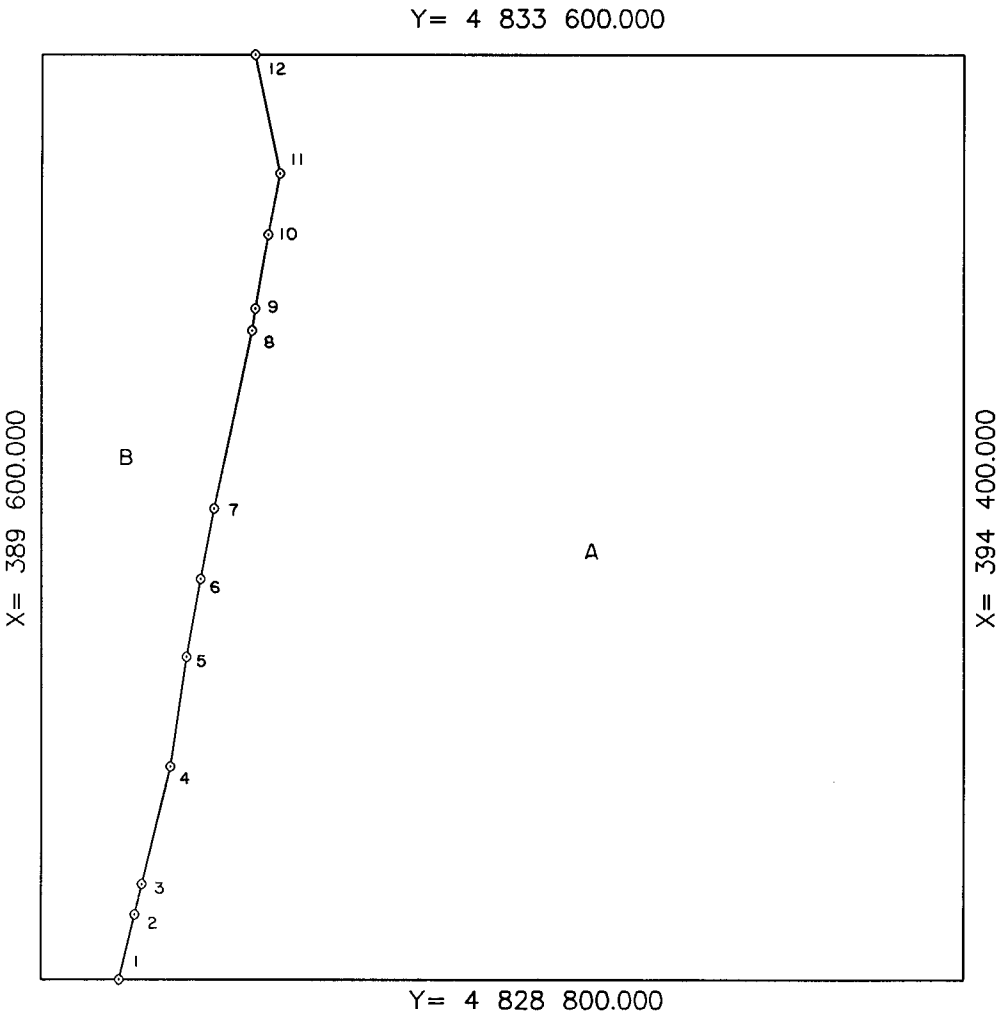

State Area \_\_\_\_\_  
Federal 8(g) Area A = 1884.342497ha  
Boundary Disputed \_\_\_\_\_  
Federal Non-8(g) Area B = 419.657503ha  
8(g) Disputed \_\_\_\_\_  
Federal Withdrawn Area \_\_\_\_\_  
Federal Deferred Area \_\_\_\_\_  
Total Area 2304.000000ha

| Offshore Intersections |             |               |
|------------------------|-------------|---------------|
|                        | X           | Y             |
| 1                      | 390 004.048 | 4 828 800.000 |
| 2                      | 390 082.288 | 4 829 143.637 |
| 3                      | 390 119.621 | 4 829 302.226 |
| 4                      | 390 266.723 | 4 829 907.196 |
| 5                      | 390 350.206 | 4 830 467.564 |
| 6                      | 390 421.430 | 4 830 874.223 |
| 7                      | 390 492.304 | 4 831 242.249 |
| 8                      | 390 687.338 | 4 832 170.410 |
| 9                      | 390 704.859 | 4 832 283.550 |
| 10                     | 390 770.748 | 4 832 664.949 |
| 11                     | 390 830.908 | 4 832 980.340 |
| 12                     | 390 701.964 | 4 833 600.000 |

| Contributing Baseline Points |             |               |
|------------------------------|-------------|---------------|
|                              | X           | Y             |
| * 1-2                        | 400 578.299 | 4 825 189.136 |
| 2-3                          | 400 917.006 | 4 826 676.770 |
| * 3-4                        | 400 917.006 | 4 826 676.770 |
| 4-5                          | 401 295.596 | 4 828 550.541 |
| * 5-6                        | 401 295.596 | 4 828 550.541 |
| 6-7                          | 401 366.820 | 4 828 957.200 |
| * 7-8                        | 401 366.820 | 4 828 957.200 |
| * 8-9                        | 401 622.954 | 4 830 176.138 |
| 9-10                         | 401 685.950 | 4 830 582.904 |
| * 10-11                      | 401 685.950 | 4 830 582.904 |
| 11-12                        | 401 640.983 | 4 835 553.048 |

\*Tangent Segment

Telma H. Harnish 07/31/98  
For the Director MMS Date

For the State Date