

DISC PAK NO.

FILE NO.

Sale No. 74
Western Gulf of Mexico
Radius 72 913.24'

UNITED STATES DEPARTMENT OF INTERIOR
~~BUREAU OF LAND MANAGEMENT~~
~~MINERALS MANAGEMENT SERVICE~~
SUPPLEMENTAL OFFICIAL
OCS 8-G BLOCK DIAGRAM

NORTH PADRE ISLAND AREA

OPD NO. TEX 2

BLOCK NO. 979

OCS LEASE NO. _____

STATE LEASE NO. _____

Y= 428 589.75'

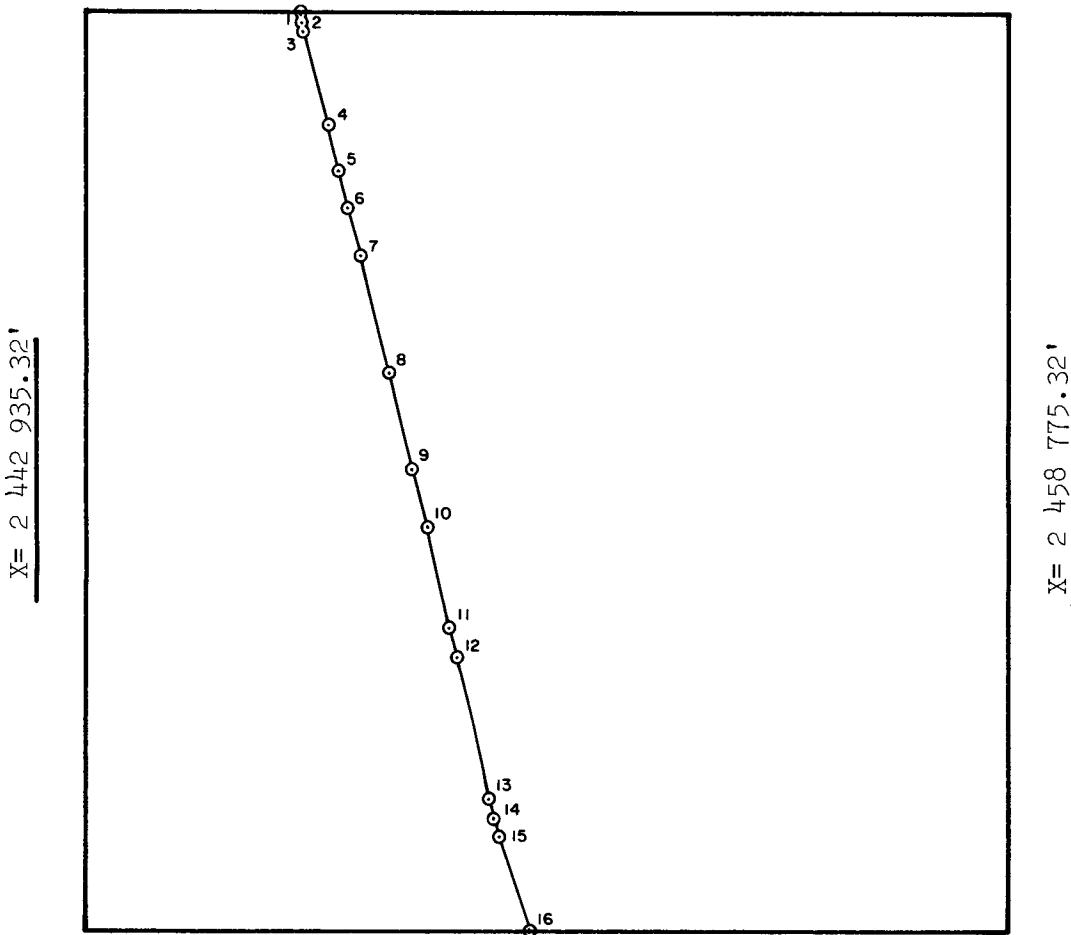

Y= 412 749.75'

INTERSECTIONS

	X	Y
1	2 446 629.29'	428 589.75'
2	2 446 683.62'	428 354.47'
3	2 446 721.24'	428 214.29'
4	2 447 134.02'	426 602.91'
5	2 447 327.02'	425 812.08'
6	2 447 468.31'	425 222.53'
7	2 447 691.39'	424 387.78'
8	2 448 192.38'	422 401.73'
9	2 448 583.61'	420 753.50'
10	2 448 804.04'	419 796.18'
11	2 449 189.54'	418 068.83'
12	2 449 326.06'	417 527.63'
13	2 449 885.77'	415 140.15'
14	2 449 979.55'	414 782.60'
15	2 450 052.52'	414 501.46'
16	2 450 530.77'	412 749.75'

ARC CENTERS

	X	Y
*1-2	2 375 532.88'	412 412.70'
*2-3	2 375 929.12'	410 696.85'
3-4	2 376 299.69'	409 315.98'
*4-5	2 376 299.69'	409 315.98'
5-6	2 376 492.69'	408 525.15'
*6-7	2 376 599.93'	407 996.05'
7-8	2 377 250.25'	405 562.64'
*8-9	2 377 250.25'	405 562.64'
9-10	2 377 541.48'	403 914.41'
*10-11	2 377 541.48'	403 914.41'
*11-12	2 378 245.49'	401 207.98'
12-13	2 378 627.40'	399 693.96'
13-14	2 379 404.95'	396 464.12'
*14-15	2 379 404.95'	396 464.12'
*15-16	2 379 592.93'	395 739.90'
*TANGENT SEGMENT		

FEDERAL AREA 3707.32 ac

STATE AREA _____

8G AREA 2052.68 ac

% _____

% _____

% _____

COMPUTATIONS BY RL DATE 3-1-83

DRAFTED BY JK DATE 3-3-83

CHECKED BY FBP DATE 4-18-83

FOR THE DIRECTOR

T. Landy
DATE 4/18/83

FOR THE STATE

DATE _____