

UNITED STATES DEPARTMENT OF INTERIOR
~~BUREAU OF LAND MANAGEMENT~~
MINERALS MANAGEMENT SERVICE

DISC PAK NO.

FILE NO.

Sale No. 74
Western Gulf of Mexico
Radius 72 913.24'

NORTH PADRE ISLAND AREA

OPD NO. TEX 2
BLOCK NO. 918
OCS LEASE NO. _____
STATE LEASE NO. _____

SUPPLEMENTAL OFFICIAL
OCS 8-G BLOCK DIAGRAM

Y= 523 629.75'

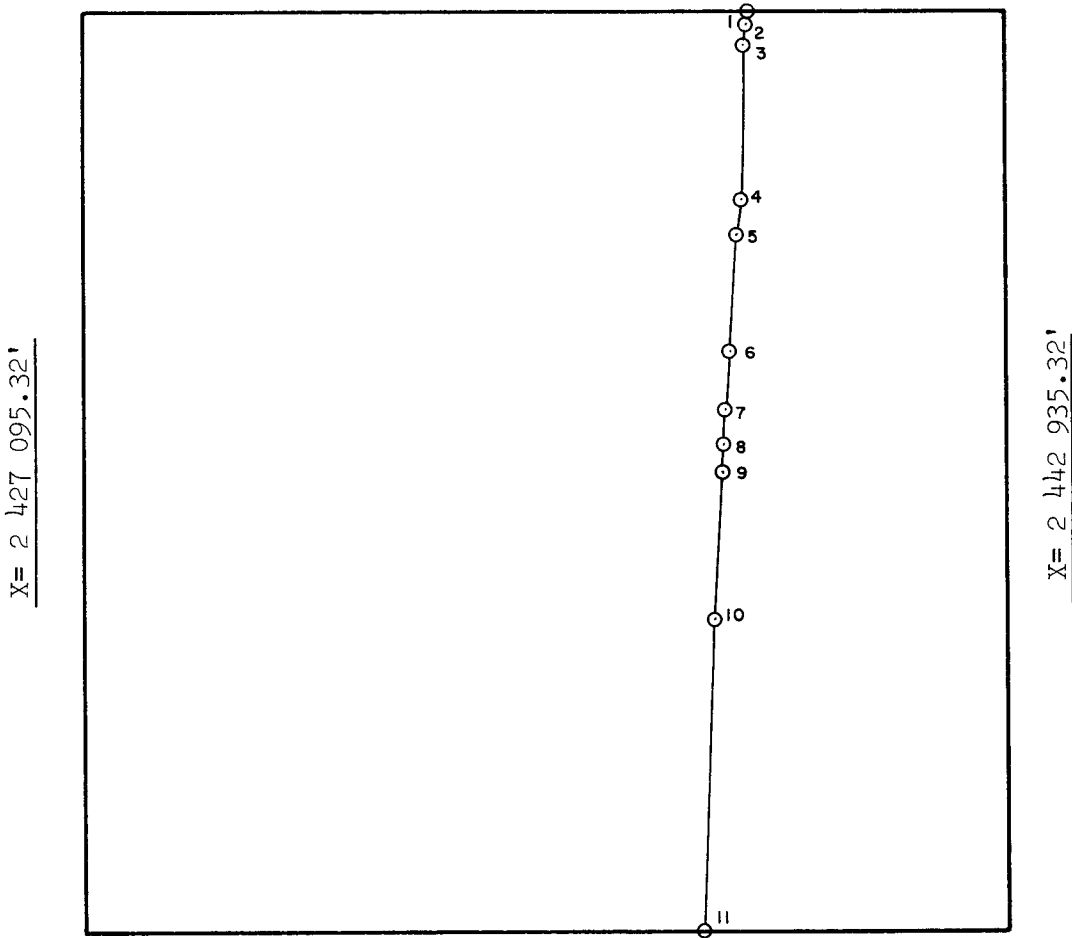

Y= 507 789.75'

INTERSECTIONS

	X	Y
1	2 438 520.35'	523 629.75'
2	2 438 515.82'	523 489.08'
3	2 438 472.97'	523 132.28'
4	2 438 392.09'	520 422.86'
5	2 438 352.11'	519 786.51'
6	2 438 222.86'	517 863.39'
7	2 438 128.38'	516 825.31'
8	2 438 100.88'	516 211.94'
9	2 438 092.58'	515 712.48'
10	2 437 958.17'	513 188.93'
11	2 437 737.95'	507 789.75'

ARC CENTERS

	X	Y
*1-2	2 365 752.00'	529 302.00'
2-3	2 366 101.61'	532 005.08'
3-4	2 365 564.35'	523 952.89'
4-5	2 365 603.00'	524 676.00'
*5-6	2 365 603.00'	524 676.00'
6-7	2 365 564.35'	523 952.89'
*7-8	2 365 419.13'	523 008.53'
*8-9	2 365 214.77'	518 450.91'
*9-10	2 365 364.00'	521 120.00'
*10-11	2 365 124.00'	516 614.00'

*TANGENT SEGMENT

FEDERAL AREA 1753.80 ac

STATE AREA _____

8G AREA 4006.20 ac

% _____

% _____

% _____

COMPUTATIONS BY MEU DATE 2-25-83

FOR THE DIRECTOR

FOR THE STATE

DRAFTED BY JV DATE 3-2-83

Selma J. Thomahlen
DATE 4/13/83

CHECKED BY JBP DATE 4-18-83

DATE _____