

DISC PAK NO.

FILE NO.

Sale No. 74  
Western Gulf of Mexico  
Radius 72 913.24'

UNITED STATES DEPARTMENT OF INTERIOR  
~~BUREAU OF LAND MANAGEMENT~~  
MINERALS MANAGEMENT SERVICE

SUPPLEMENTAL OFFICIAL  
OCS 8-G BLOCK DIAGRAM

MUSTANG ISLAND AREA

OPD NO. TEX 3

BLOCK NO. 878

OCS LEASE NO. \_\_\_\_\_

STATE LEASE NO. \_\_\_\_\_

Y= 586 989.75'

X= 2 442 935.32'

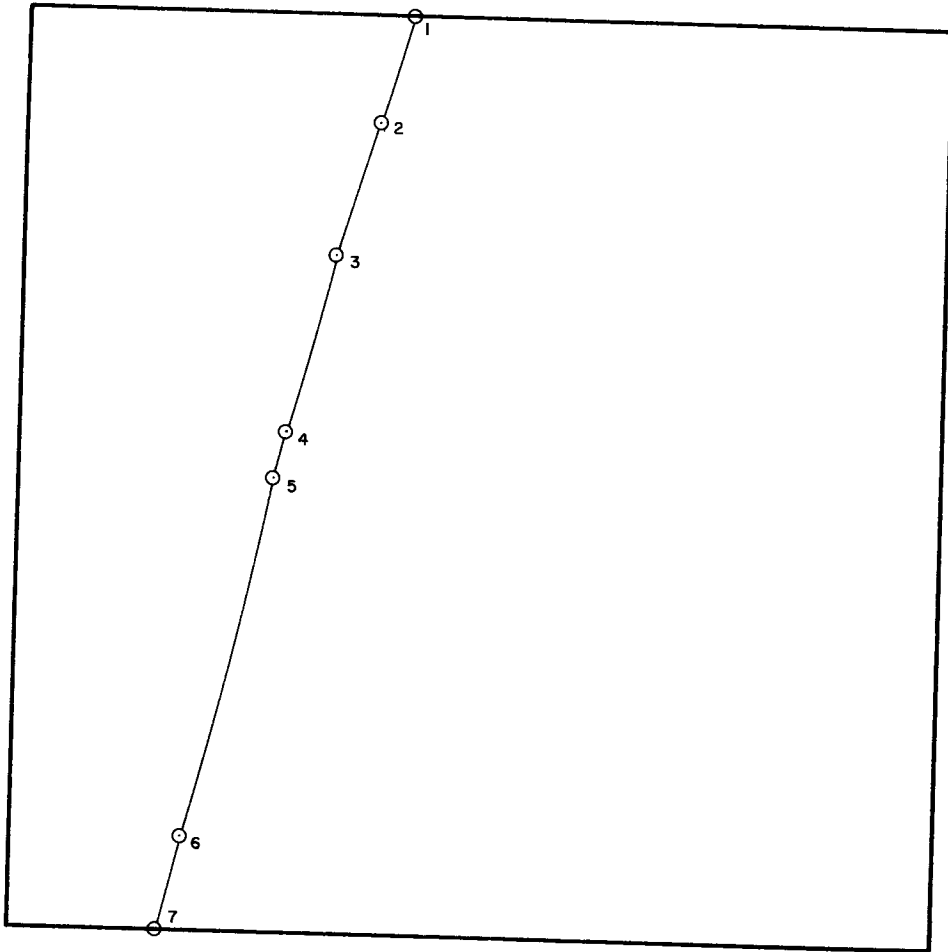

X= 2 458 775.32'

Y= 571 149.75'

INTERSECTIONS

	X	Y
1	2 449 555.67'	586 989.75'
2	2 449 007.80'	585 139.68'
3	2 448 297.84'	582 853.81'
4	2 447 535.77'	579 718.99'
5	2 447 331.21'	578 951.86'
6	2 445 857.47'	572 762.94'
7	2 445 521.47'	571 149.75'

ARC CENTERS

	X	Y
1-2	2 379 375.72'	606 766.39'
*2-3	2 379 375.72'	606 766.39'
3-4	2 377 084.35'	598 505.62'
*4-5	2 377 084.35'	598 505.62'
5-6	2 375 731.90'	592 731.55'
6-7	2 374 312.62'	586 822.65'

\*TANGENT SEGMENT

FEDERAL AREA 4122.91 ac

% \_\_\_\_\_

STATE AREA \_\_\_\_\_

% \_\_\_\_\_

8G AREA 1637.09 ac

% \_\_\_\_\_

COMPUTATIONS BY HEV DATE 2-15-83

DRAFTED BY QV DATE 3-3-83

CHECKED BY JOP DATE 4-18-83

FOR THE DIRECTOR

Leland F. Hornmiller  
DATE 4/18/83

FOR THE STATE

DATE \_\_\_\_\_