

UNITED STATES DEPARTMENT OF INTERIOR  
~~BUREAU OF LAND MANAGEMENT~~  
MINERALS MANAGEMENT SERVICE  
SUPPLEMENTAL OFFICIAL  
OCS 8-G BLOCK DIAGRAM  
MUSTANG ISLAND AREA

DISC PAK NO.

FILE NO.

Sale No. 74  
Western Gulf of Mexico  
Radius 72 913.24'

OPD NO. TEX 3

BLOCK NO. 865

OCS LEASE NO. \_\_\_\_\_

STATE LEASE NO. \_\_\_\_\_

Y= 602 829.75'

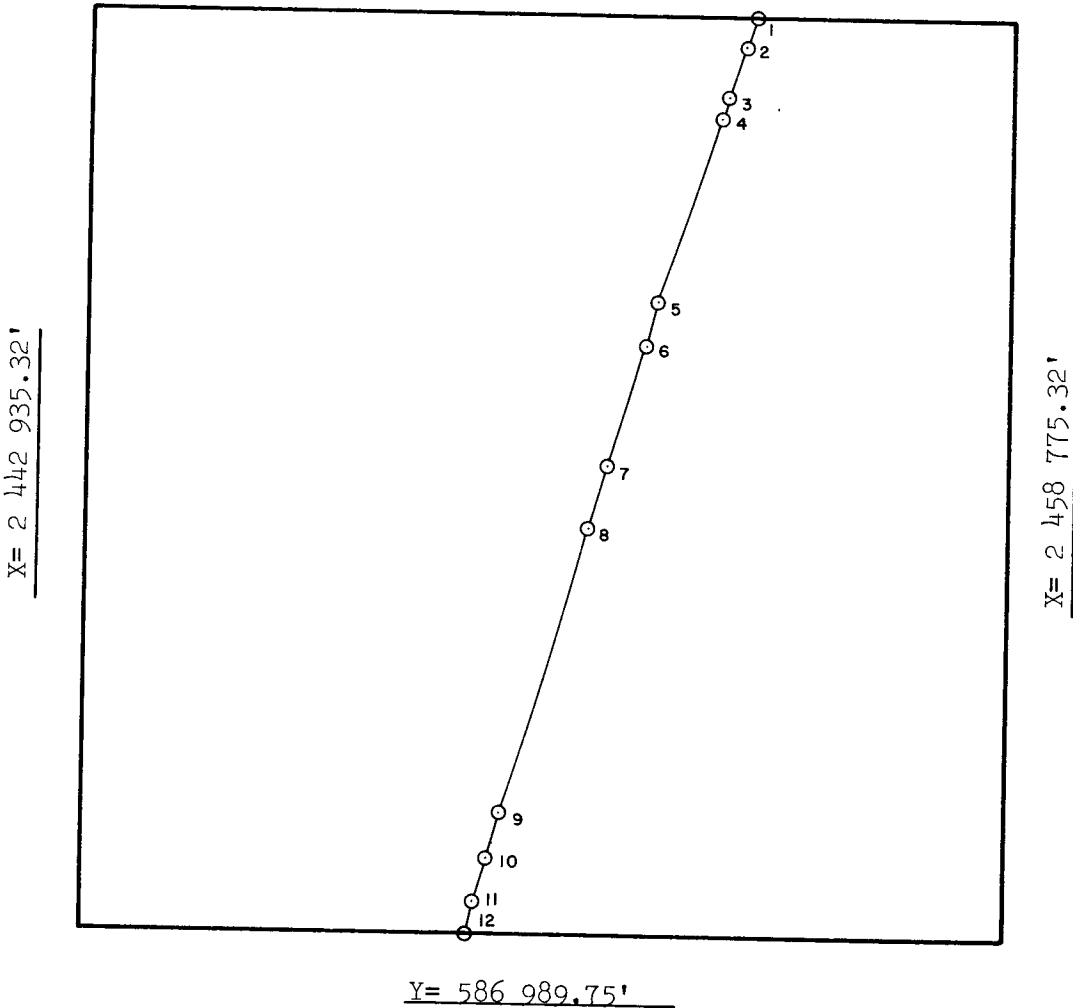

INTERSECTIONS

	X	Y
1	2 454 331.06'	602 829.75'
2	2 454 175.28'	602 326.37'
3	2 453 870.13'	601 444.68'
4	2 453 764.74'	601 100.62'
5	2 452 709.61'	597 919.20'
6	2 452 485.98'	597 125.87'
7	2 451 863.44'	595 037.46'
8	2 451 515.96'	593 932.37'
9	2 450 116.74'	589 048.91'
10	2 449 901.73'	588 245.85'
11	2 449 699.34'	587 506.85'
12	2 449 555.67'	586 989.75'

ARC CENTERS

	X	Y
*1-2	2 385 829.00'	628 108.00'
2-3	2 385 120.81'	625 731.94'
*3-4	2 384 786.42'	624 863.42'
4-5	2 384 049.05'	622 456.27'
*5-6	2 382 910.75'	619 047.73'
6-7	2 382 307.71'	616 908.46'
*7-8	2 382 307.71'	616 908.46'
8-9	2 380 766.02'	611 561.52'
9-10	2 379 578.11'	607 505.39'
*10-11	2 379 578.11'	607 505.39'
11-12	2 379 375.72'	606 766.39'

\*TANGENT SEGMENT

FEDERAL AREA 2510.80 ac

% \_\_\_\_\_

STATE AREA \_\_\_\_\_

% \_\_\_\_\_

8G AREA 3249.20 ac

% \_\_\_\_\_

COMPUTATIONS BY JKV DATE 2-25-83

DRAFTED BY JKV DATE 3-3-83

CHECKED BY JBP DATE 4-18-83

FOR THE DIRECTOR

Edward J. Hummel  
DATE 4/18/83

FOR THE STATE

DATE \_\_\_\_\_