

UNITED STATES DEPARTMENT OF INTERIOR
~~BUREAU OF LAND MANAGEMENT~~
MINERALS MANAGEMENT SERVICE
SUPPLEMENTAL OFFICIAL
OCS 8-G BLOCK DIAGRAM

DISC PAK NO.

FILE NO.

Sale No. 74
Radius 72 913.24'

MATAGORDA ISLAND AREA

Western Gulf of Mexico

OPD NO. TEX 4
BLOCK NO. 528
OCS LEASE NO. _____
STATE LEASE NO. _____

Y= 198 000.00'

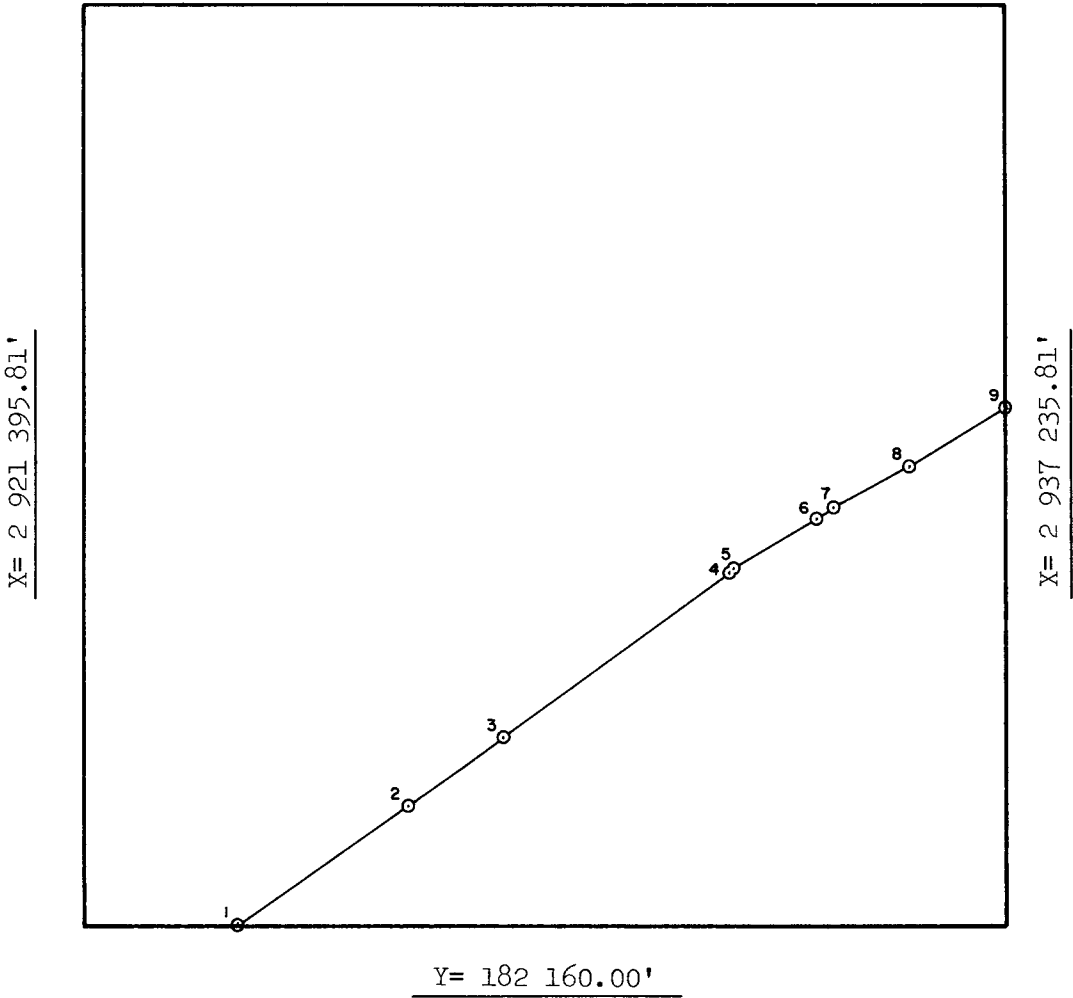

INTERSECTIONS

| | X | Y |
|---|---------------|-------------|
| 1 | 2 924 031.56' | 182 160.00' |
| 2 | 2 926 931.05' | 184 184.71' |
| 3 | 2 928 567.73' | 185 361.59' |
| 4 | 2 932 454.25' | 188 238.59' |
| 5 | 2 932 541.98' | 188 303.63' |
| 6 | 2 933 956.36' | 189 147.53' |
| 7 | 2 934 247.78' | 189 308.66' |
| 8 | 2 935 558.21' | 190 050.98' |
| 9 | 2 937 235.81' | 191 024.31' |
| | | |
| | | |

ARC CENTERS

| | X | Y |
|------|---------------|-------------|
| *1-2 | 2 882 266.88' | 241 926.65' |
| 2-3 | 2 885 186.30' | 243 965.28' |
| *3-4 | 2 885 186.30' | 243 965.28' |
| 4-5 | 2 889 072.82' | 246 842.28' |
| *5-6 | 2 893 808.38' | 250 098.53' |
| *6-7 | 2 897 626.72' | 252 376.76' |
| 7-8 | 2 898 967.37' | 253 118.01' |
| *8-9 | 2 898 967.37' | 253 118.01' |
| | | |
| | | |

*TANGENT SEGMENT

FEDERAL AREA 1400.90 ac
% _____

STATE AREA _____
% _____

8G AREA 4359.10 ac
% _____

COMPUTATIONS BY GEC DATE 3/16/83
DRAFTED BY QV DATE 3-18-83
CHECKED BY FBO DATE 4-18-83

FOR THE DIRECTOR
Teland f. Hornsby
DATE 4/19/83

FOR THE STATE

DATE _____