

UNITED STATES DEPARTMENT OF INTERIOR
~~BUREAU OF LAND MANAGEMENT~~
MINERALS MANAGEMENT SERVICE
SUPPLEMENTAL OFFICIAL
OCS 8-G BLOCK DIAGRAM

DISC PAK NO.

FILE NO.

Sale No. 74
Radius 54 684.93'

Western Gulf of Mexico

MATAGORDA ISLAND AREA

OPD NO. TEX 4
BLOCK NO. 487
OCS LEASE NO. _____
STATE LEASE NO. _____

Y= 229 680.00'

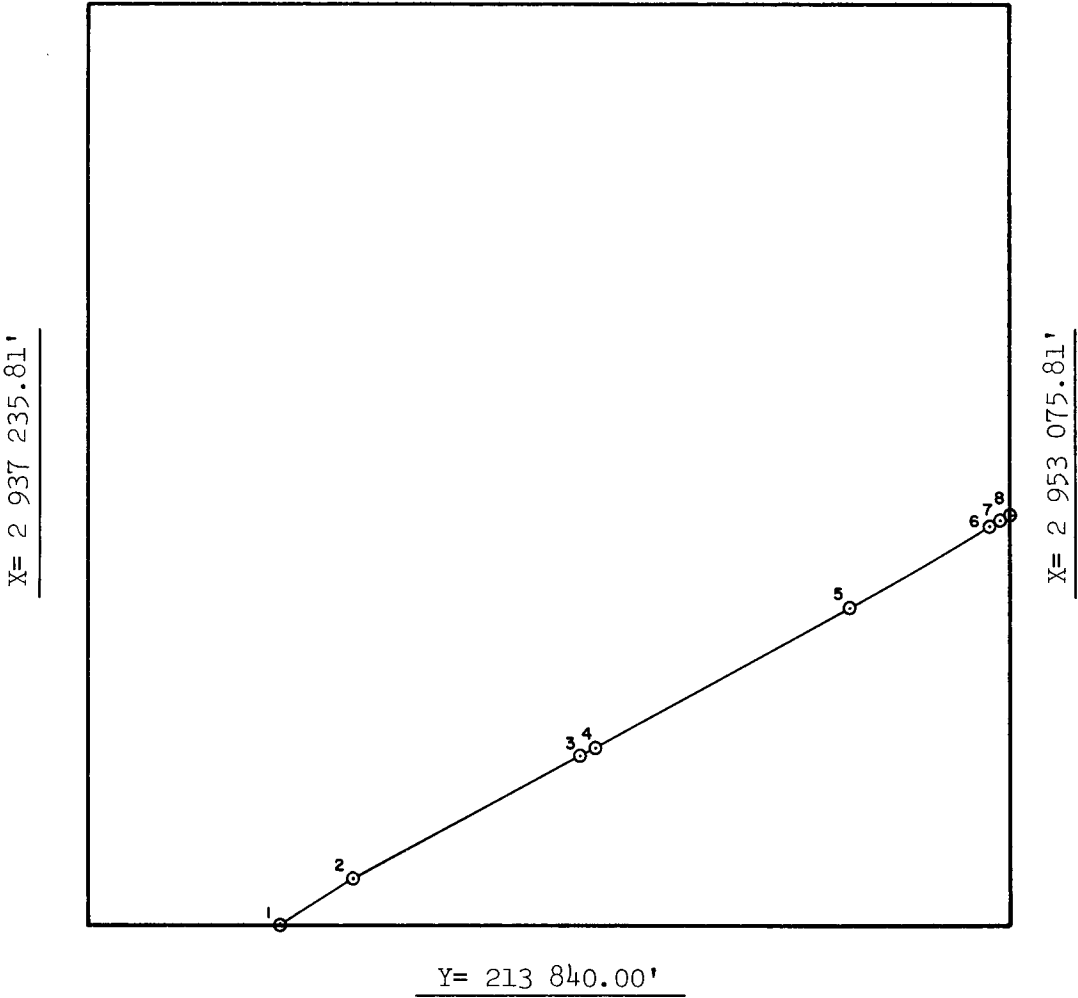

INTERSECTIONS

	X	Y
1	2 940 542.19'	213 840.00'
2	2 941 803.06'	214 584.41'
3	2 945 705.86'	216 708.22'
4	2 945 971.37'	216 853.66'
5	2 950 356.99'	219 271.78'
6	2 952 750.81'	220 671.97'
7	2 952 941.73'	220 766.74'
8	2 953 075.81'	220 833.53'

ARC CENTERS

	X	Y
*1-2	2 912 224.16'	260 625.58'
*2-3	2 914 824.47'	262 160.78'
3-4	2 919 567.15'	264 741.64'
*4-5	2 919 567.15'	264 741.64'
5-6	2 923 952.77'	267 159.76'
*6-7	2 927 627.71'	269 252.71'
7-8	2 928 628.00'	269 749.23'

*TANGENT SEGMENT

FEDERAL AREA _____
% _____

STATE AREA 4756.51 ac
% _____

8G AREA 1003.49 ac
% _____

COMPUTATIONS BY GLC DATE 3/16/83
DRAFTED BY W DATE 3-18-83
CHECKED BY JBP DATE 4-18-83

FOR THE DIRECTOR
Ieland J. Hornsblom
DATE 4/18/83

FOR THE STATE
Jack Gibson
DATE JUN 03 1983