

UNITED STATES DEPARTMENT OF INTERIOR  
~~BUREAU OF LAND MANAGEMENT~~  
**MINERALS MANAGEMENT SERVICE**  
**SUPPLEMENTAL OFFICIAL**  
**OCS 8-G BLOCK DIAGRAM**  
GALVESTON AREA

DISC PAK NO.

FILE NO.

Sale No. 74  
Western Gulf of Mexico  
Radius 72 913.24'

OPD NO. TEX 6  
BLOCK NO. 332  
OCS LEASE NO. \_\_\_\_\_  
STATE LEASE NO. \_\_\_\_\_

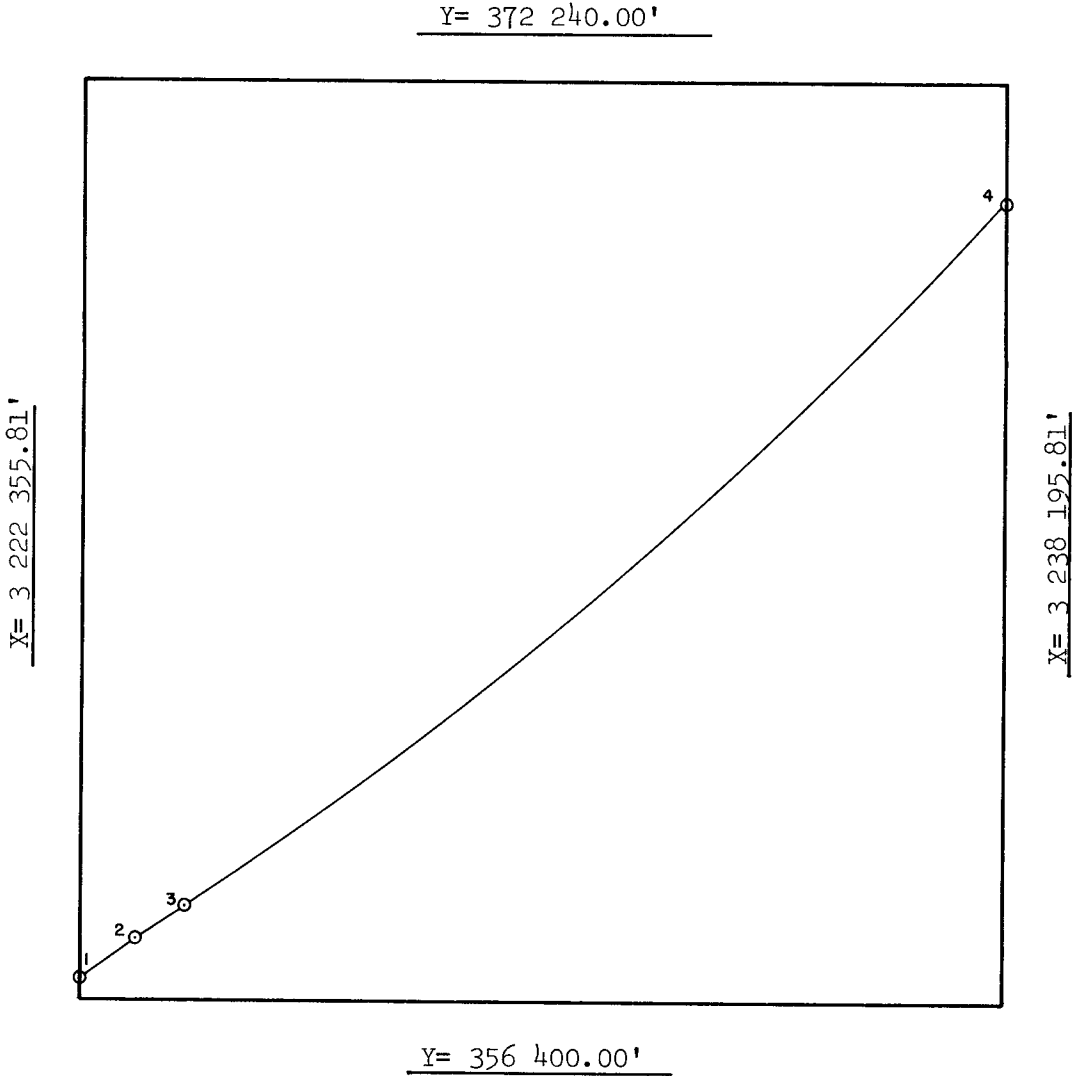

INTERSECTIONS

	X	Y
1	3 222 355.81'	356 767.44'
2	3 223 361.79'	357 425.40'
3	3 224 205.79'	357 987.40'
4	3 238 195.81'	370 130.28'

ARC CENTERS

	X	Y
1-2	3 182 950.00'	418 115.00'
*2-3	3 182 950.00'	418 115.00'
3-4	3 183 794.00'	418 677.00'

\*TANGENT SEGMENT

FEDERAL AREA 2333.50 ac  
% \_\_\_\_\_

STATE AREA \_\_\_\_\_  
% \_\_\_\_\_

8G AREA 3426.50 ac  
% \_\_\_\_\_

COMPUTATIONS BY RS DATE 4-4-83  
DRAFTED BY JK DATE 4-6-83  
CHECKED BY FBP DATE 4-20-83

FOR THE DIRECTOR  
Telma J. Lamm  
DATE 4/20/83

FOR THE STATE  
\_\_\_\_\_  
DATE \_\_\_\_\_