

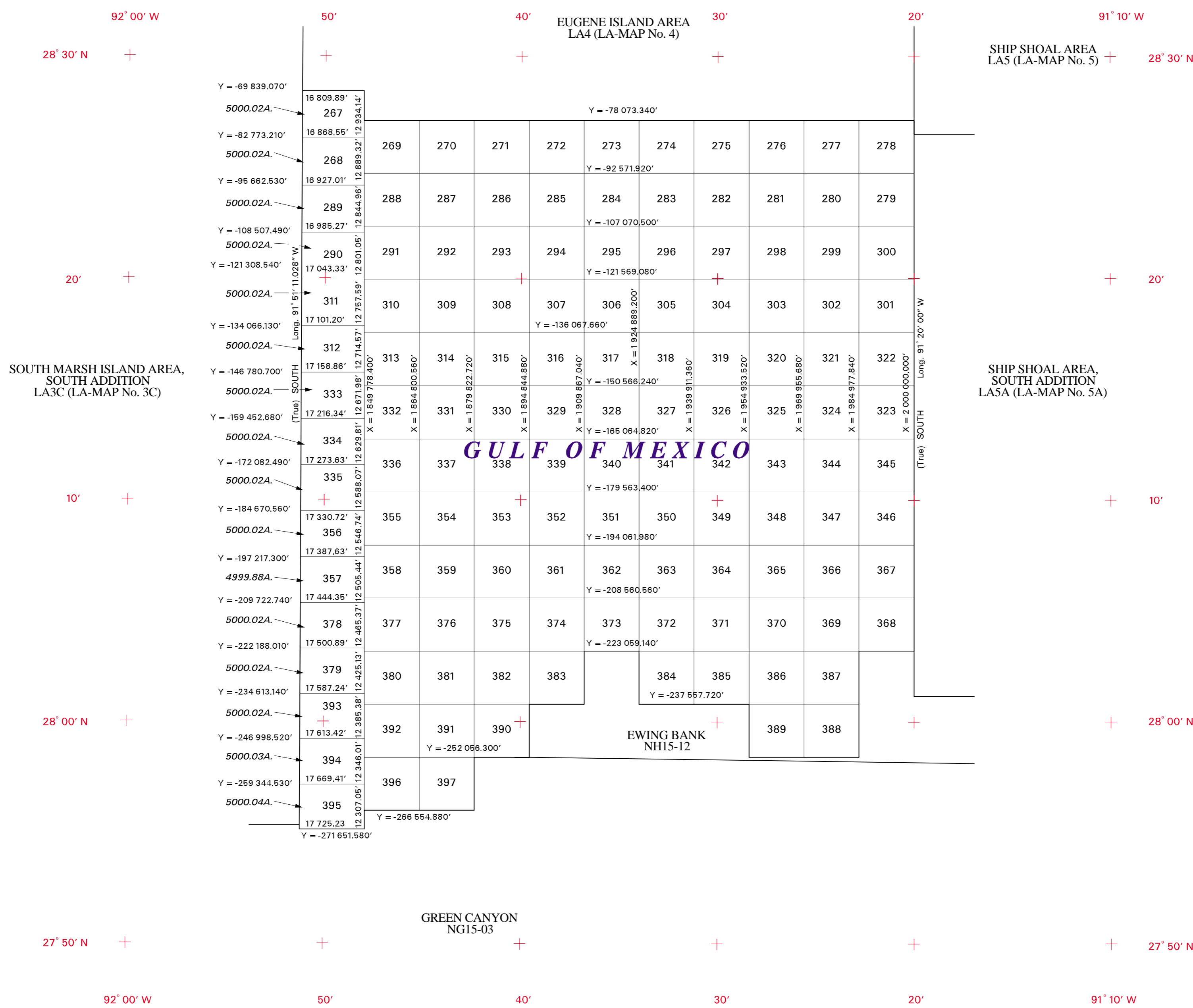

**LOUISIANA
GULF COAST INDEX**

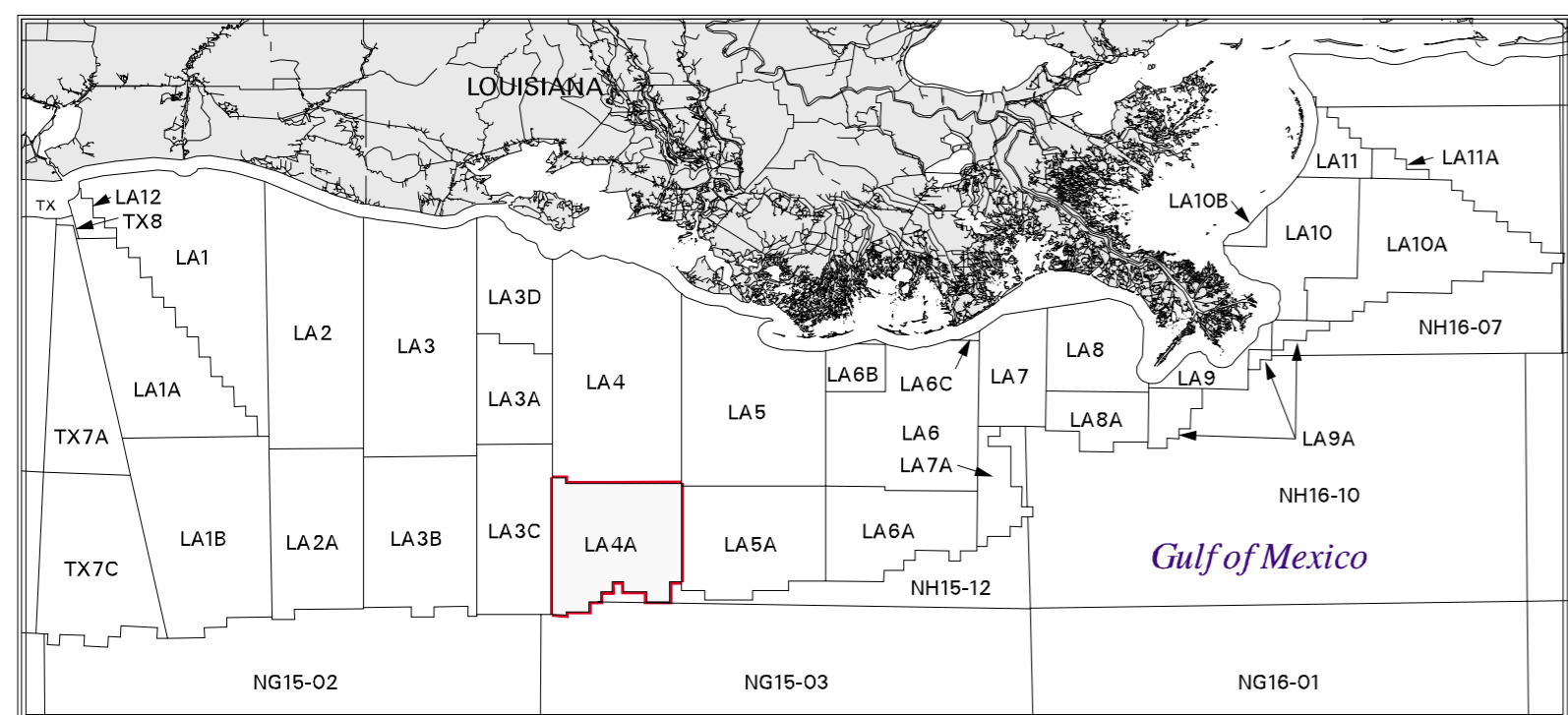

All blocks are based on the Louisiana (Lambert) Plane Coordinate System, South Zone, with X origin = 2,000,000' at 91° 20' W and Y origin = 0.00' at 28° 40' N.

Regular blocks (Grid Values) are 15,022.16 feet in the X direction and 14,498.58 feet in the Y direction and contain 5,000 acres. Areas and dimensions of the irregular blocks are as indicated.

This revised map supersedes leasing map EUGENE ISLAND AREA, SOUTH ADDITION, LA-MAP No. 4A, approved 08-SEP-1959, revised 01-JUN-1988, and LA4A revised 01-SEP-1999.

Copies of these diagrams and other information may be obtained at the appropriate MMS OCS Region.

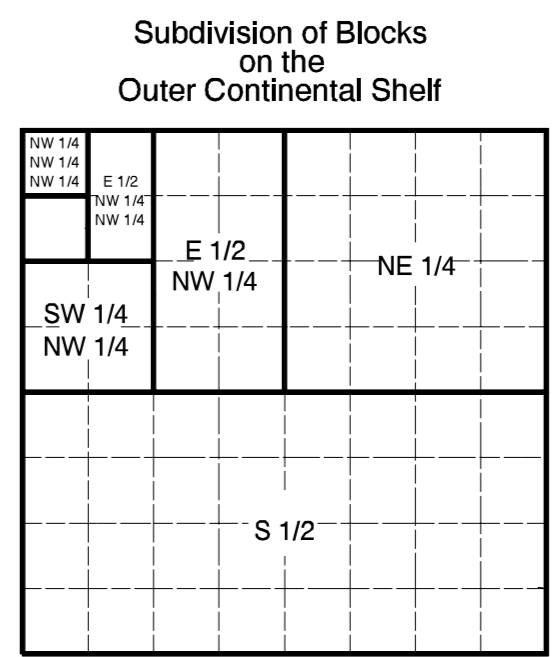

Typical method of subdivision of the regular blocks, each subdivision being an aliquot part of the total, based on midpoint subdivision throughout.

**UNITED STATES DEPARTMENT OF THE INTERIOR
MINERALS MANAGEMENT SERVICE
OUTER CONTINENTAL SHELF LEASING MAP
LOUISIANA**

NORTH AMERICAN DATUM OF 1927

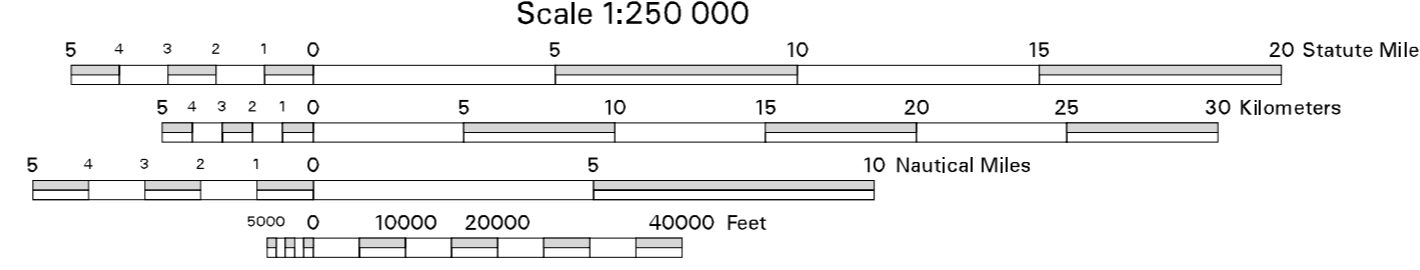

This diagram is prepared in accordance with 30 CFR 256.8

For the Director
Island E. Hymahala
Chief, Leasing Division, Mapping and Boundary Branch
Denver, Colorado Date 01-NOV-2000

Revised